



DigiPro®

USER'S GUIDE

MODEL 6900 SERIES



3 Safety Instructions

4 Product View

5 Assembly

6 Special Tools

6-9 Operation / Maintenance

10 Troubleshooting

10 Consumer Services

11 Replacement Parts

12 Warranty

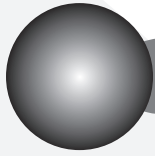

Thanks for buying a BISSELL DigiPro®

We're glad you purchased a BISSELL DigiPro® Vacuum. Everything we know about floor care went into the design and construction of this lightweight and versatile vacuum.

Your BISSELL DigiPro® is well made, and we back it with a limited one-year warranty. We also stand behind it with a knowledgeable, dedicated Consumer Services department, so, should you ever have a problem, you'll receive fast, considerate assistance.

My great-grandfather invented the floor sweeper in 1876. Today, BISSELL is a global leader in the design, manufacture, and service of high quality homecare products like your BISSELL DigiPro® Vacuum.

Thanks again, from all of us at BISSELL.

Mark J. Bissell
President and Chief Executive Officer

IMPORTANT SAFETY INSTRUCTIONS

When using an electrical appliance, basic precautions should be observed, including the following:

Read all instructions before using your canister vacuum cleaner.

 **WARNING:** To reduce the risk of fire, injury or electric shock:

- Do not leave cleaner when it is plugged in.
- Unplug from outlet when not in use and before servicing.
- Do not use with damaged cord or plug.
- To unplug grasp plug not cord.
- Do not pull or carry by cord, use cord as a handle, close door on cord, pull cord around sharp corners, run cleaner over cord, or expose cord to heated surfaces.
- Hold plug when rewinding the cord onto the reel. Do not allow the plug to whip when rewinding.
- Do not use cleaner if it has been dropped, damaged, left outdoors or dropped into water. Have it repaired at an Authorized Service Center.
- Do not allow children to use as a toy.
- Do not use outdoors or on wet surfaces.
- Do not handle cleaner or plug with wet hands.
- Do not put any object into openings, use with blocked opening, or restrict air flow.
- Do not use without vacuum bag and/or filters in place.
- Do not allow hair, loose clothing, fingers or body parts to get near openings or floor brush in the appliance.
- Do not pick up hot coals, cigarette butts, matches or any hot, smoking, or burning objects.
- Do not pick up hard or sharp objects such as glass, nails, screws, coins, etc.
- Do not pick up flammable or combustible materials (lighter fluid, gasoline, kerosene, etc.) or use in the presence of explosive liquids or vapor.
- Do not unplug by pulling on cord.

- Do not pick up toxic material (chlorine bleach, ammonia, drain cleaner, etc.).
- Do not use in an enclosed space filled with vapors given off by oil base paint, paint thinner, some moth proofing substances, flammable dust, or other explosive or toxic vapors.
- Do not use for any purpose other than described in this User's Guide.
- Always turn off this appliance before connecting or disconnecting vacuum hose.
- Use only manufacturer's recommended attachments.
- Use only on dry, indoor surfaces.
- Keep openings free of dust, lint, hair, etc.
- Keep appliance on a level surface.
- Turn off all controls before plugging or unplugging cleaner.
- Be extra careful when cleaning stairs.
- Close attention is necessary when used by or near children.

WARNING: The Power Cord on this product contains lead, a chemical known to the State of California to cause birth defects or other reproductive harm. **WASH HANDS AFTER HANDLING.**

SAVE THESE INSTRUCTIONS. THIS APPLIANCE HAS A POLARIZED PLUG.

To reduce the risk of electric shock, this appliance has a polarized plug (one blade is wider than the other). This plug will fit in a polarized outlet only one way. If the plug does not fit fully in the outlet, reverse the plug. If it still does not fit, contact a qualified electrician to install a proper outlet. Do not change the plug in any way.

This model is for household use only.

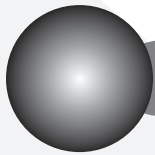

Product View

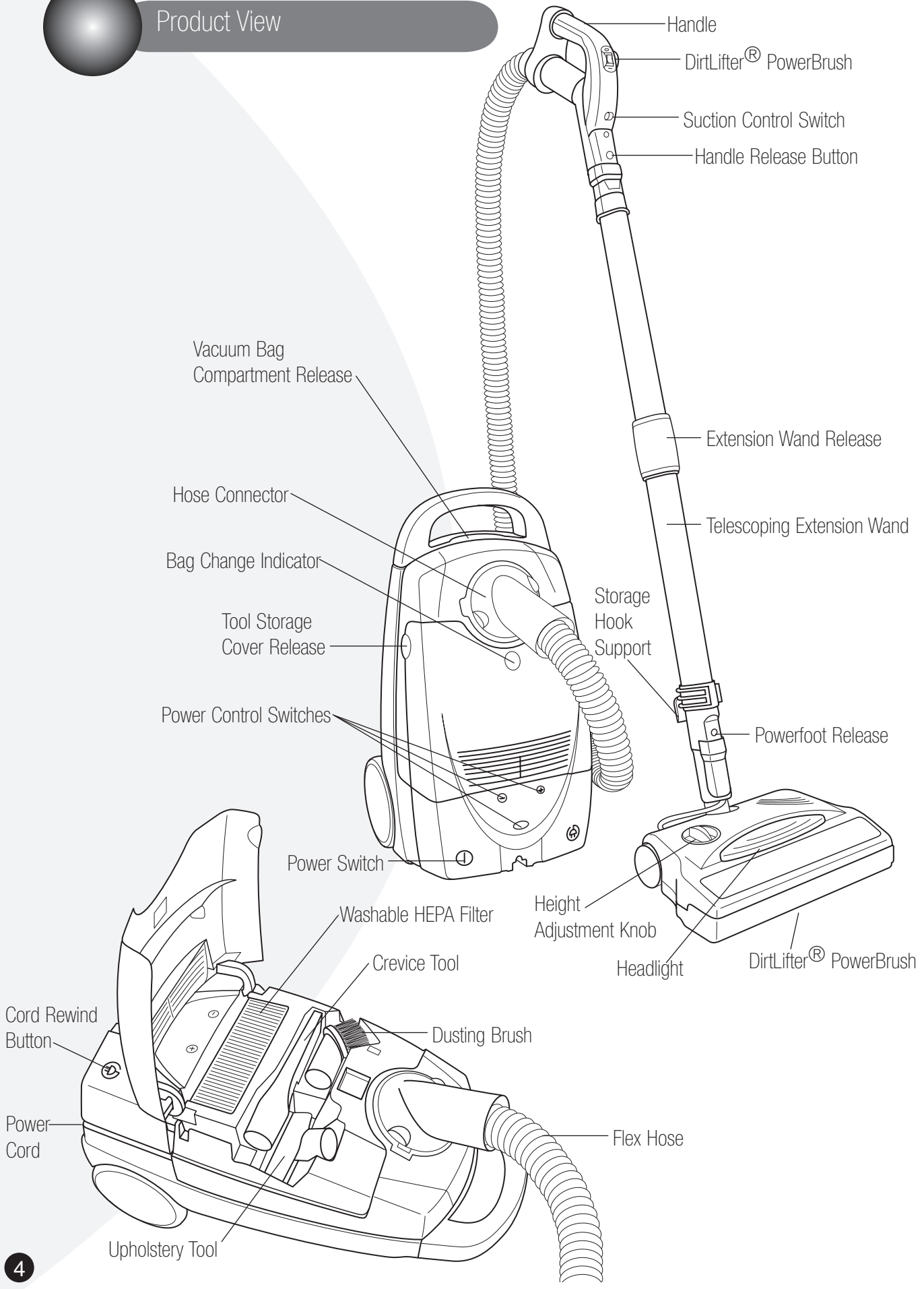

How To Use This Guide

This User's Guide is designed to help you gain the best performance from your BISSELL® DigiPro® Vacuum Cleaner. Inside you will find assembly and operating instructions, safety precautions, maintenance and troubleshooting instructions. Please read through this Guide thoroughly before assembling and using your vacuum cleaner. Refer to the Product View to locate and familiarize yourself with its parts and features. This will be helpful in assembling the unit and in finding the proper location of parts when you perform routine maintenance. Additional diagrams are included in the maintenance and troubleshooting sections to simplify those tasks.



WARNING:

Do not plug in your DigiPro® until you have completely assembled it according to the following instructions and have become familiar with all instructions and operating procedures.

Assembly

The DigiPro is packaged for convenience and can be assembled without the need for tools.

1.

The top of the Extension Wand is the rounded section. Place one hand on the Extension Wand Release, the black plastic grip just below the top of the Extension Wand. Hold the top part of the Extension Wand with one hand and pull down on the Extension Wand Release until the Wand is fully extended.

2.

The bottom of the Extension Wand features a rounded back and a flat front, with two plug holes visible on the underside. Align the flat side with the power prongs in the Powerfoot base. Slide the Wand onto the Powerfoot base. It should click into place. Lift the unit slightly to make sure the connection is secure.

3.

The Handle features a rounded back and a flat front, with two plug holes visible on the underside. Align the flat side with the power prongs in the Extension Wand. Slide the Handle onto the Extension Wand. It should click into place. Lift the unit slightly to make sure the connection is secure.

4.

Slide open the Hose Connection Door on the canister unit. Align the arrow on the top of the Hose Connector with the arrow on the inside of the suction unit. Press down to secure.

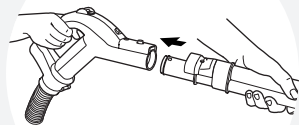
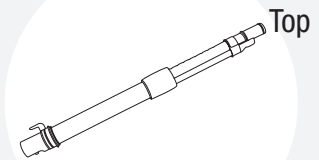

Hose
Connection
Door

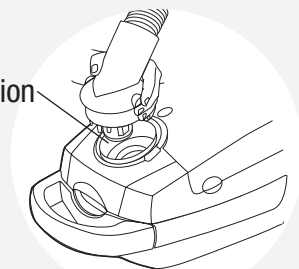

Special Tools

The DigiPro comes with a Crevice Tool, Dusting Brush, and Upholstery Tool. Tools are stored inside the canister unit. To reach them, simply lift up the Tool Storage Cover Release. Tools may be attached on the Handle or, where longer reach is needed, to the Extension Wand.

1.

To attach a Tool to the Handle, press the Handle Release button and pull up until the Handle disconnects from the Extension Wand. Slide the Handle over the Tool. Make sure it is secure before using.

2.

To attach a Tool to the Extension Wand, press the Powerfoot Release button near the base of the Powerfoot and pull up until the Extension Wand is released from the Powerfoot. Slide the Extension Wand over the Tool. Make sure it is secure before using.

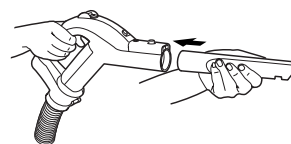

Operation / Maintenance

The DigiPro handles all types of basic household cleaning needs. It can be used on all types of carpeting, wood floors, linoleum, upholstery, and curtains. It can be adjusted manually for any operation or set to respond automatically to each surface. Its wide coverage area makes it ideal for cleaning in corners and along baseboards. Its easily maneuverable canister fits on stairways and can be used with the Extension Wand and Tools to clean curtains and hard-to-reach spaces.

Power Cord

The Power Cord is located in the rear of the unit. Pull out the Power Cord gently. It will extend up to 22 feet. When removing the Power Cord from the electrical outlet, switch off the power and grasp the plug. Your vacuum is equipped with an automatic rewind button. When cleaning is finished, switch off the power and disconnect the plug from the electrical outlet. Press the Cord Rewind Button (Ⓜ) and the cord will rewind automatically.

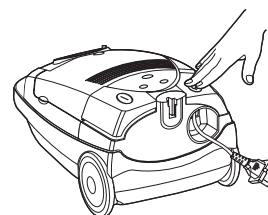

Power Switch

With the Power Cord plugged into an electrical outlet, turn the power on and off by pushing or stepping lightly downward on the Power Switch (Ⓜ).

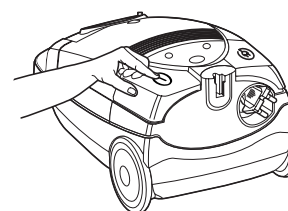

DirtLifter® PowerBrush Switch

Located on the Handle, this activates the Brush Roll for carpet and most floor cleaning operations.

Suction Control Switch

Located on the Handle, the Suction Control Switch slides to vary suction for multiple cleaning tasks like draperies or other delicate surfaces.

Power Control Switches

The power can be adjusted to suit many cleaning situations.

1.

Variable Power Controls

Allows for optimum manual setting for each cleaning task. Press appropriate button for task:

 = For delicate fabrics or low suction

e = Economy setting for normally soiled surfaces or normal suction

 = For hard floors/heavily soiled surfaces or maximum suction

2.

Automatic Power Control

Automatically adjusts to surface to optimize setting for each cleaning task. For this feature, press the  button.

Bag Change Indicator

The Bag Change Indicator will monitor the airflow through the Vacuum Bag and turn red when it's time to replace the bag. The Vacuum Bag may appear to be very full or only partially full depending upon the type of debris picked up and the airflow blockage.

Tip:

There must be a Vacuum Bag in the canister for the door to properly latch.

Replacing Vacuum Bag

1.

Unplug vacuum.

2.

Press the Vacuum Bag Compartment Release and lift door out from canister. Remove the Vacuum Bag by sliding it off the Vacuum Bag retainer. Dispose of used bag.

3.

Slide the new Vacuum Bag onto the retainer. Make sure the opening is fully exposed.

4.

Make sure the Vacuum Bag is tucked fully inside the unit before closing the canister housing. Press down gently on the door until it locks into place.

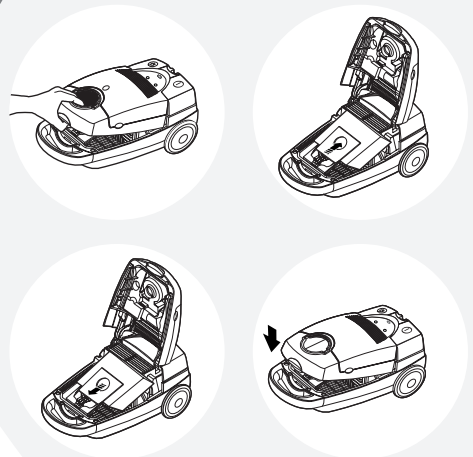

Storage Position

Located at the top rear side of the vacuum cleaner, there is a Nozzle Support that can be used to park the nozzle during pauses in cleaning or while in storage. Insert the Storage Hook Support into the Nozzle Support. There is also a Nozzle Support located on the back of the vacuum which can be used when the vacuum is in the vertical position for storage or transportation.

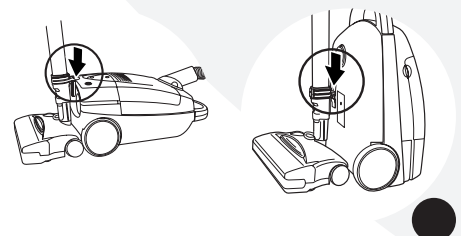

Washable Pre-Motor Filter

The Pre-Motor Filter prevents dust and debris from interfering with the operation of your vacuum. It should be regularly checked for wear or damage and replaced when torn.

1. Pull up on the Vacuum Bag Compartment Release lever to open the canister. The Pre-Motor Filter is attached inside the unit, behind the Vacuum Bag.
2. Slide the filter out of the attachment channel. The filter may be gently cleaned by washing in warm water with a mild detergent. Allow filter to dry completely before reinstalling. If filter is torn, replace with a new filter.
3. Install filter. Slide into attachment channel. Press down to secure. Close canister.

Pre-Motor Filter

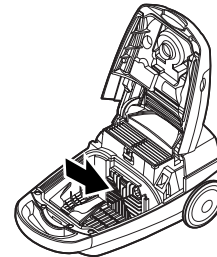

Washable HEPA Filter & Post-Motor Filter

The filters are located in the canister of your vacuum cleaner. The HEPA Filter is designed to promote optimum cleaning efficiency, as well as the removal of dust mites, pollen, and ragweed. Both filters should be regularly checked, and cleaned if they appear dirty or if you notice excessive amounts of dust inside the canister. They need to be replaced if severely damaged or torn.

1. Pull up on the Vacuum Bag Compartment Release lever to open the canister. The HEPA Filter is at the top and features a locking tab.
2. Pull up on the tab and lift out the filter. Below the HEPA Filter is the Post-Motor Filter.
3. The filters may be gently cleaned by washing in warm water with a mild detergent. Allow filters to dry completely before reinstalling. If either filter is torn, replace with new filter.
4. Reinstall filters. Press down on the HEPA Filter locking tab. The filter should snap into place. Close canister.

HEPA Filter

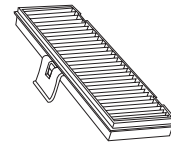

Post-Motor Filter

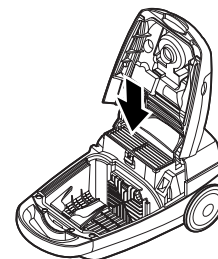

DirtLifter® PowerBrush

The Brush and Drive Belt should both regularly be checked for wear or damage. You should also keep the Brush and Brush Ends free of string, hair, and carpet fibers as these can become entangled in the Brush and reduce its cleaning effectiveness.

Cleaning the DirtLifter[®] PowerBrush

The Brush can usually be cleaned without removal from the vacuum. If there is an excessive amount of hair and debris, however, it is best to remove the Brush.

⚠ WARNING:
Unplug from outlet when not in use and before servicing.

1. Pressing down on the Powerfoot Release button, detach the Powerfoot from the Extension Wand.
2. Lay the Powerfoot face forward on the floor.
3. Locate the locking screws (6) on the bottom of the Powerfoot. Using a Phillips head screwdriver, remove the screws. Lift off the Brush Cover. Grasp the Brush firmly, and pull it out. The Brush has metal end caps featuring a square at the center. They can be removed for easier cleaning, but make sure they are properly reinserted before installing the Brush. Remove the Drive Belt from the roller, set aside.
4. Clean debris from Brush. Lint, carpet pile, and hair can be removed with a pair of scissors. If brush bristles are worn or missing, replace Brush.
5. Slide Belt over Brush onto the belt track. Slide Belt over the Motor Pulley. To reinstall Brush, slide square ends of Brush into grooves, beginning with the Belt side. The Drive Belt should have room to rotate within the belt channel. Make sure Drive Belt is looped over roller and not twisted. Inspect Belt action by rolling the Brush with the palm of your hand.
6. Reattach Brush Cover to Powerfoot with (6) screws.

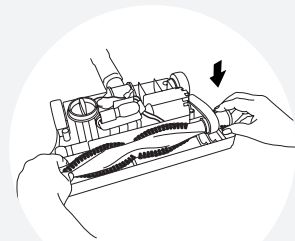
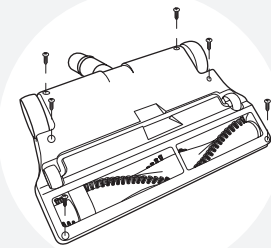

Replacing the Drive Belt

1. Follow steps 1, 2 and 3 from the "Cleaning the DirtLifter[®] PowerBrush" section.
2. Remove old Belt from Brush.
3. Attach new Belt, aligning as indicated in step 5 and 6 from the "Cleaning the DirtLifter[®] PowerBrush" section.

Replacing The Light Bulb

1. To replace the Light Bulb in the Powerfoot, follow steps 1, 2 and 3 from "Cleaning the DirtLifter[®] PowerBrush" section.
2. Remove old Bulb from Bulb Socket. Insert new Bulb.
3. Refer to step 5 and 6 from "Cleaning the DirtLifter[®] PowerBrush" section.

Troubleshooting

Vacuum Cleaner Won't Run.

Possible Causes

- ❶ Vacuum cleaner is not plugged in
- ❷ Household fuse/circuit breaker

Remedies

- ❶ Check electrical plug
Check electrical connection
- ❷ Check/replace fuse
Reset breaker

Vacuum Cleaner Won't Pick Up Dirt.

Possible Causes

- ❶ Powerfoot, Extension Wand or Filters are blocked or clogged
- ❷ Vacuum Bag is full.
- ❸ Brush is jammed
- ❹ Brush bristles are worn
- ❺ Rotating Brush Belt loose or broken

Remedies

- ❶ Check each for blockage
- ❷ Replace Vacuum Bag
- ❸ Remove Brush and clean debris from end of Brush
- ❹ Replace Brush
- ❺ Realign Belt; if broken replace

Cord Does Not Rewind Fully.

Possible Cause

- ❶ Cord may be twisted or wound unevenly

Remedies

- ❶ Gently pull out the cord and push down on the Cord Rewind Button

BISSELL Consumer Services

For information about repairs or replacement parts, or questions about your warranty, call:

BISSELL Consumer Services

1-800-237-7691

Monday - Friday 8 a.m. — 10 p.m. ET

Saturday 9 a.m. — 8 p.m. ET

Or write:

BISSELL Homecare, Inc.

PO Box 3606

Grand Rapids MI 49501

ATTN: Consumer Services

Or visit the BISSELL website - **www.bissell.com**

When contacting BISSELL, have model number of unit available.

Please record your Model Number: _____

Please record your Purchase Date: _____

NOTE: Please keep your original sales receipt. It is your warranty.

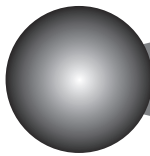

Replacement Parts

You may purchase replacement parts from your retailer, by calling BISSELL Consumer Services or by visiting our website. To locate a retailer near you, or to place an order using Visa, Mastercard, Discover or American Express, call:

BISSELL Consumer Services

1-800-237-7691

Monday - Friday 8 a.m. — 10 p.m. ET

Saturday 9 a.m. — 8 p.m. ET

Or visit our website - www.bissell.com

Item	Part No.	Part Name
1	32033	Belt-Power Foot (2-pack)
2	203-4402	Brush-Power Foot
3	203-1007	Light Bulb-Power Foot
4	203-4404	Telescoping Extension Wand
5	203-4406	Hose with Handle
6	203-4413	Washable Pre-Motor Filter (white)
7	203-4411	Washable HEPA Filter
8	203-4407	Washable Post Motor Filter (black)
9	32115	Vacuum Bags (3-pack)
10	203-4410	Crevice Tool
11	203-1083	Dusting Brush
12	203-4408	Upholstery Tool

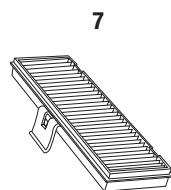
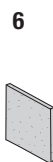
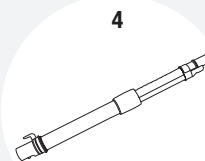
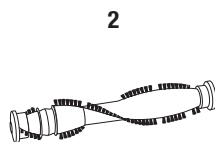
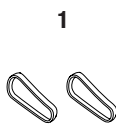



Warranty

This warranty gives you specific legal rights, and you may also have other rights which may vary from state to state. If you need additional instruction regarding this warranty or have questions regarding what it may cover, please contact BISSELL Consumer Services by e-mail, telephone, or regular mail as described below.

Limited One Year Warranty

Subject to the *EXCEPTIONS AND EXCLUSIONS identified below, upon receipt of the product, BISSELL Homecare, Inc. will repair or replace (with new or remanufactured components or products), at BISSELL's option, free of charge from the date of purchase by the original purchaser, for one year any defective or malfunctioning part.

See information below on "If your BISSELL product should require service."

This warranty applies to product used for personal, and not commercial or rental service. This warranty does not apply to fans or routine maintenance components such as filters, belts, or brushes. Damage or malfunction caused by negligence, abuse, or use not in accordance with the User's Guide is not covered.

If your BISSELL product should require service:

Call BISSELL Consumer Services at the number listed below or visit the BISSELL website - www.bissell.com to locate a BISSELL Authorized Service Center in your area.

If you need information about repairs or replacement parts, or if you have questions about your warranty, contact BISSELL Consumer Services.

Website or E-mail:

www.bissell.com

Use the "Customer Services" tab.

Or Call:

BISSELL Consumer Services

1-800-237-7691

Monday - Friday 8 a.m. - 10 p.m. ET

Saturday 9 a.m. - 8 p.m. ET

Or Write:

BISSELL Homecare, Inc.

PO Box 3606

Grand Rapids MI 49501

ATTN: Consumer Services

BISSELL HOMECARE INC. IS NOT LIABLE FOR INCIDENTAL OR CONSEQUENTIAL DAMAGES OF ANY NATURE ASSOCIATED WITH THE USE OF THIS PRODUCT. BISSELL'S LIABILITY WILL NOT EXCEED THE PURCHASE PRICE OF THE PRODUCT.

Some states do not allow the exclusion or limitation of incidental or consequential damages, so the above limitation or exclusion may not apply to you.

*EXCEPTIONS AND EXCLUSIONS FROM THE TERMS OF THE LIMITED WARRANTY

THIS WARRANTY IS EXCLUSIVE AND IN LIEU OF ANY OTHER WARRANTIES EITHER ORAL OR WRITTEN. ANY IMPLIED WARRANTIES WHICH MAY ARISE BY OPERATION OF LAW, INCLUDING THE IMPLIED WARRANTIES OF MERCHANTABILITY AND FITNESS FOR A PARTICULAR PURPOSE, ARE LIMITED TO THE ONE YEAR DURATION FROM THE DATE OF PURCHASE AS DESCRIBED ABOVE.

Some states do not allow limitations on how long an implied warranty lasts, so the above limitation may not apply to you.



©2005 BISSELL Homecare, Inc.
Grand Rapids, Michigan
All rights reserved. Printed in China
Part Number 603-4424
Rev 08/05
Visit our website at:
www.bissell.com