

Experts In Home Cleaning™

LIFT-Off™ STEAM MOP

USER'S GUIDE

23B6-Z SERIES 220V-240V

- 2 Thank You
- 3 Safety Instructions
- 4 Product View
- 5 Assembly
- 6-8 Operations
- 9 Maintenance and Care
- 10 Troubleshooting
- 10 Replacement Parts
- 10 Accessories
- 11 Warranty
- 12 Product Registration
- 12 Consumer Services



Thanks for buying a BISSELL Lift-Off™ Steam Mop

We're glad you purchased a BISSELL Lift-Off Steam Mop. Everything we know about floor care went into the design and construction of this complete, high-tech home cleaning system.

Your BISSELL Lift-Off Steam Mop is well made, and we back it with a limited two year warranty. We also stand behind it with a knowledgeable, dedicated Consumer Services department, so, should you ever have a problem, you'll receive fast, considerate assistance.

My great-grandfather invented the floor sweeper in 1876. Today, BISSELL is a global leader in the design, manufacture, and service of high quality homecare products like your BISSELL Lift-Off Steam Mop.

Thanks again, from all of us at BISSELL.

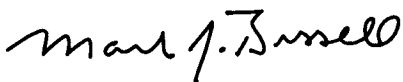

Mark J. Bissell
Chairman & CEO

IMPORTANT SAFETY INSTRUCTIONS

When using an electrical appliance, basic precautions should be observed, including the following:

READ ALL INSTRUCTIONS BEFORE USING STEAM MOP.

Always connect to a properly Earthed outlet. Unplug from outlet when not in use and before conducting maintenance or troubleshooting.

WARNING: To reduce the risk of fire, electric shock, or injury:

- Use indoors only
- Do not immerse
- Use only on surfaces moistened by cleaning process
- Do not leave machine when it is plugged in
- Do not service machine when it is plugged in
- If the supply cord is damaged, it must be replaced by the manufacturer or its service agent in order to avoid a hazard
- Do not use machine if it has been dropped, damaged, left outdoors or dropped into water
- Do not expose to rain, store indoors
- Do not pull or carry by cord, use cord as a handle, close door on cord, pull cord around sharp corners or edges, run appliance over cord, or expose cord to heated surfaces
- Do not carry the appliance while in use
- Do not unplug by pulling on cord; unplug by grasping plug not the cord
- Do not handle plug or appliance with wet hands
- Do not put any object into appliance openings, use with blocked opening or restrict air flow
- Do not expose hair, loose clothing, fingers or body parts to openings or moving parts
- Do not pick up hot or burning objects
- Do not pick up flammable or combustible materials (lighter fluid, petrol, kerosene, etc.) or use in the presence of explosive liquids or vapours
- Do not use appliance in an enclosed space filled with vapours given off by oil base paint, paint thinner, some moth proofing substances, flammable dust, or other explosive or toxic vapours
- Remove plug from electrical outlet before cleaning or maintaining the appliance

- Not intended for use by persons (including children) with reduced physical, sensory or mental capabilities, or lack of experience and knowledge, unless they have been given supervision or instruction concerning use of the appliance by a person responsible for their safety
- Young children should be supervised to ensure that they do not play with the appliance
- Do not pick up toxic material (chlorine bleach, ammonia, drain cleaner, petrol, etc.)
- Do not modify the Earthed plug
- Do not allow to be used as a toy
- Do not use for any purpose other than described in this User's Guide
- Use only manufacturer's recommended attachments
- Use only cleaning products formulated by BISSELL for use in this appliance to prevent internal component damage
- Keep openings free of dust, lint, hair, etc.
- Keep appliance on a level surface
- Turn off all controls before unplugging
- Be extra careful when cleaning stairs
- Liquid or steam must not be directed towards equipment containing electrical components
- Pay close attention when working around children.

SAVE THESE INSTRUCTIONS

THIS MODEL IS FOR HOUSEHOLD USE ONLY.

WARNING:

This appliance must be Earthed.

 The symbol  means
WARNING: Danger of scalding.

 Surface may be hot. Avoid contact.

IMPORTANT FOR
OPERATION ON A 220-240 VOLT A.C.
50/60 Hz POWER SUPPLY ONLY.

If your appliance is fitted with a nonwireable BS 1363 plug it must not be used unless a 13 amp (ASTA approved to BS 1362) fuse is fitted in the carrier contained in the plug. Spares may be obtained from your BISSELL supplier. If for any reason the plug is cut off, it must be disposed of, as it is an electric shock hazard should it be inserted into a 13 amp socket.

Product view



Assembly

Your Lift-Off Steam Mop assembles quickly and easily. The only thing you will need for assembly is a Phillips head screwdriver.

Your Lift-Off Steam Mop is packaged with the following items:

Handle Assembly

Lower Body base

Detachable Steam Pod with water purification

Maneuverable Swivel Head

Removable Water Tank

1 small Phillips Head Screw taped to the handle

2 Deluxe Mop Pads

1. Attach lower body base to maneuverable swivel head.
2. Secure maneuverable swivel head with small Phillips head screw. Tighten until secure.
3. Slide handle assembly down into lower body base until it will go no further. Secure the handle by turning the knob until tight.

Lift-Off Steam Mop assembly is now complete.



Operations

Features and accessories

Removable water tank

The water tank is located on the front of the Lift-Off Steam Mop. It can be refilled with water any time during use. Distilled or demineralized water may be used in place of tap water.

Do not use chemicals with your Lift-Off Steam Mop (not including BISSELL Eucalyptus Mint Natural water product).

Water purification system

This filter removes minerals and other impurities from tap water, preventing water deposits from damaging your Lift-Off Steam Mop. It should be replaced when the bright green grains turn blue. To maximize performance of the filter, distilled water may be used.

Ready light

The ready light will glow when the Lift-Off Steam Mop is ready to use.

Steam on demand trigger

Press to release steam.

Maneuverable swivel head

Use to clean around furniture and hard to reach areas on the floor.

Mop pads

Reuseable microfiber mop pad is machine washable and safe for all hard floor surfaces.

Circular scrubbing brush tool

Attach to end of the hose for scrubbing stubborn soil and hard to reach areas. Color coded for specific use. Red for bathrooms and black for the kitchen.

Grout brush tool

Attach to end of the hose for scrubbing small cracks and crevices.

Flat surface Microfiber pad cleaning tool

Attach flat surface with pad to the end of the adaptor. Attach to the end of the hose for cleaning large flat surfaces.

Window squeegee

Attach the Window Squeegee to the end of the adaptor. Attach to the end of the hose.

Tip:

Do not attempt to use your Lift-Off Steam Mop without water in the tank.



CAUTION:

Thermal shock can shatter glass. Before cleaning cold glass surfaces, carefully warm the surface by directing the steam jet on the glass from a distance at no less than four to six inches.

Operations

Getting ready

1. Attach mop pad
 - A. Set the mop pad flat on the floor.
 - B. Line up the mop head and place it inside the mop pad with cord located at rear of mop head. Tighten cord to ensure tight fit.
2. Fill water tank
 - A. Remove tank by lifting straight up and away from the unit.
 - B. Unscrew cap and remove from tank.
 - C. Fill water tank with water. For best results, water should be at room temperature.
 - D. Replace the assembly cap and tighten until snug.
 - E. Replace water tank by lining up vertical guides and gently sliding tank into place.
3. Select a steam control setting. Light is for delicate floors such as hardwood and laminates. Normal is for everyday cleaning, and Tough is for hard to clean messes.
4. Twist the Quick Release™ cord wrap clockwise to unwrap the power cord completely and plug into a 220V-240V grounded outlet as described on the Important Safety Instructions, page 3.
5. The ready light will illuminate in 30 seconds when the Lift-Off Steam Mop is ready for use.

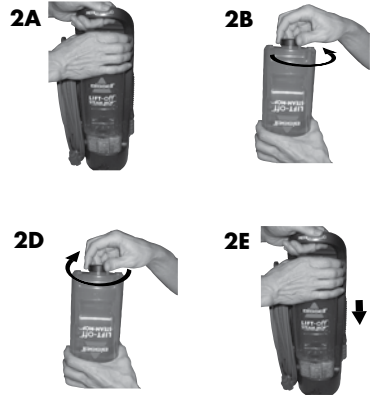

Before you clean

Thoroughly sweep or vacuum floor prior to cleaning with the Lift-Off Steam Mop.

Cleaning hard floors

Your Lift-Off Steam Mop is designed to clean hard flooring such as ceramic tile, vinyl, laminate, marble, stone and sealed hard wood floors. Use of your Lift-Off Steam Mop on waxed or some unwaxed floors may result in a diminished glossiness. The Lift-Off Steam Mop is not for use on unsealed wood floors. For best results test in an inconspicuous area and check the care instructions from your flooring manufacturer.

Operations

Cleaning hard floors continued

1. When the ready light illuminates, begin cleaning by slowly passing over surface while pressing the steam on demand trigger to emit steam as needed.
2. To sanitize an area of your floor, (attack invisible germs and bacteria) place the center of the Lift-Off Steam Mop over the spot for a minimum 15 seconds, but no longer than 20 seconds. For larger areas, overlap swivel head placement.
3. When the Lift-Off Steam Mop stops emitting steam, simply remove the water tank, refill, and continue cleaning.

NOTE: upon first use of this steam product or first use of a new filter, the pump may make a "knocking" sound while the filter fills with water. This sound is normal and may last up to one minute. Continue to depress the trigger until the knocking sound subsides and the unit emits steam.

Steam cleaning all living areas

Stubborn messes that resist traditional water and cleaning solutions can be removed with steam. Toothpaste or hair spray on the bathroom sink, soap scum on sliding shower walls—steam makes all these far easier to clean.

1. Fill the water tank with cool tap water or distilled/demineralized water and replace back on Detachable Steam Pod.
2. Remove Steam Pod by pressing the pod release button on the top of the carry handle and pulling the pod out and away from the lower base.
3. Remove cord from pod and connect the plug to an appropriate outlet.
4. Remove hose from pod by pressing the clip at the end of the hose where it connects to the detachable pod.
5. Connect desired tool to the end of the hose.
6. When blue ready light turns on, the steamer is ready to use.
7. To activate steam, press the pod release button on the top of the carry handle. To stop steaming, release the pod release button.



WARNING:

Never put descaling, aromatic (not including the BISSELL Eucalyptus Mint and water products), alcoholic or detergent product into the steam cleaner, as this may damage it or make it unsafe for use.

Tip:

During first use, it may take several seconds for the Lift-Off Steam Mop to begin steaming. The water needs to flow through the filter to the heater. This delay will only occur during initial use or when using a new filter.

Maintenance and care

When you're done

1. Unplug power cord from outlet.
2. Carefully remove mop pad from swivel head, as mop pad and lower assembly will be hot.
3. Any water remaining in the water tank should be emptied prior to machine storage.
4. Mop pad can be machine washed in warm water. Use only liquid detergents. Do not use bleach or fabric softeners; for best results, air dry.
5. Wrap power cord around quick release cord wrap on side of Detachable Steam Pod.

Replacing the water filter

If you fill your Lift-Off Steam Mop cleaner with normal tap water, it is essential to check the water purification system and replace it when it is no longer effective. Change the filter when the bright green grains turn blue. If the filter is not changed at the appropriate time, calcium deposits will accumulate on the heating element, causing damage or reduced performance.

Using distilled or demineralized water will maximize the performance of your filter.

To order a replacement water purification system, refer to the replacement parts section on page 10.



CAUTION:

Upright storage of the Lift-Off Steam Mop with a wet mop pad may result in the formation of white marks on your floor. To remove the white marks, clean area with vinegar.

Tip:

Using distilled or demineralized water will maximize the performance of your filter.

Tip:

Be sure to use only a BISSELL water filter in your Lift-Off Steam Mop.

Troubleshooting

Reduced steam or no steam.

Possible Causes

1. Water tank empty
2. Depleted water filter

Remedies

1. Fill tank
2. Replace filter

Other maintenance or service not included in the manual should be performed by an authorized service representative.

Thank you for selecting a BISSELL product.

Please do not return this product to the store.

For any questions or concerns, BISSELL is happy to be of service. Contact us directly at 4000.860.369.

Replacement parts - BISSELL Lift-Off Steam Mop

Item	Part No.	Part Name
1	3252-2	Water Filter
2	203-2275	Water Tank with Cap and Insert
3	203-2276	Cap and Insert Assembly
4	203-2274	White Flat Surface Pad
5	71X9	Microfiber Mop Pads - 2 pack
6	3252-1	Eucalyptus Mint Natural Aroma
7	59V4	Steam Mop Scented Water Eucalyptus Mint 32 FL oz
8	203-7899	Window Squeegee
9	203-2277	Grout Brush
10	203-2279	Detail Brushes (2)

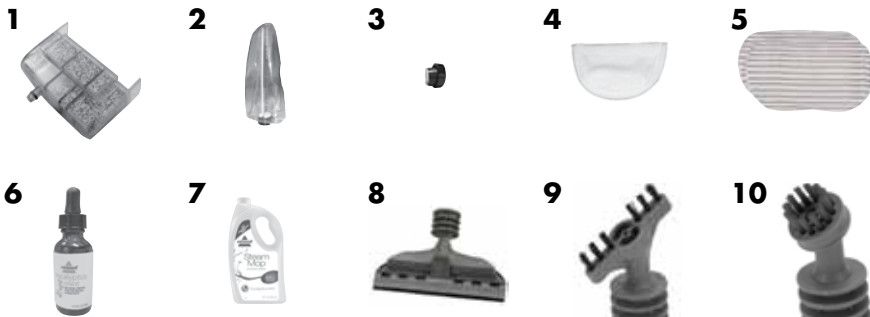

Warranty BISSELL Lift-Off Steam Mop

This warranty gives you specific legal rights, and you may also have other rights that may vary from state to state. If you need additional instruction regarding this warranty or have questions regarding what it may cover, please contact BISSELL Consumer Services by E-mail, telephone, or regular mail as described below.

Limited Two Year Warranty

Subject to the *EXCEPTIONS AND EXCLUSIONS identified below, upon receipt of the product BISSELL will repair or replace (with new or remanufactured components or products), at BISSELL's option, free of charge from the date of purchase by the original purchaser, for two years any defective or malfunctioning part.

See information below on "If your BISSELL product should require service".

This warranty applies to product used for personal, and not commercial or rental service. This warranty does not apply to fans or routine maintenance components such as filters, belts, or brushes. Damage or malfunction caused by negligence, abuse, neglect, unauthorized repair, or any other use not in accordance with the User's Guide is not covered.

If your BISSELL product should require service:

Contact BISSELL Consumer Services to locate a BISSELL Authorized Service Center in your area.

If you need information about repairs or replacement parts, or if you have questions about your warranty, contact BISSELL Consumer Services.

Website or E-mail:

www.bissell.com

Or Call:

BISSELL Consumer Services

4000.860.369

Monday - Friday 9 am - 6 pm

Friday - 9 am - 4 pm

BISSELL IS NOT LIABLE FOR INCIDENTAL OR CONSEQUENTIAL DAMAGES OF ANY NATURE ASSOCIATED WITH THE USE OF THIS PRODUCT. BISSELL'S LIABILITY WILL NOT EXCEED THE PURCHASE PRICE OF THE PRODUCT.

Some states do not allow the exclusion or limitation of incidental or consequential damages, so the above limitation or exclusion may not apply to you.

*EXCEPTIONS AND EXCLUSIONS FROM THE TERMS OF THE LIMITED WARRANTY

THIS WARRANTY IS EXCLUSIVE AND IN LIEU OF ANY OTHER WARRANTIES EITHER ORAL OR WRITTEN. ANY IMPLIED WARRANTIES WHICH MAY ARISE BY OPERATION OF LAW, INCLUDING THE IMPLIED WARRANTIES OF MERCHANTABILITY AND FITNESS FOR A PARTICULAR PURPOSE, ARE LIMITED TO THE TWO YEAR DURATION FROM THE DATE OF PURCHASE AS DESCRIBED ABOVE.

Some states do not allow limitations on how long an implied warranty last so the above limitation may not apply to you.

NOTE: Please keep your original sales receipt. It provides proof of date of purchase in the event of a warranty claim.

Don't forget to register your product!

Registering is quick, easy and offers you benefits over the lifetime of your product. You'll receive:

Faster Service

Supplying your information now saves you time should you need to contact us with questions regarding your product.

Product Support Reminders and Alerts

We'll contact you with any important product maintenance reminders and alerts.

Special Promotions

Optional: Register your email to receive notice of offers, contests, cleaning tips and more!

Visit www.bissell.com/registration now!

BISSELL consumer services

For information about repairs or replacement parts, or questions about your warranty, call:

BISSELL Consumer Services

4000.860.369

Monday – Friday - 9 am - 6 pm

Or visit the BISSELL website - **www.bissell.com**

When contacting BISSELL, have model number of cleaner available.

Please record your Model Number: _____

Please record your Purchase Date: _____

NOTE: Please keep your original sales receipt. It provides proof of purchase date in the event of a warranty claim. See Warranty on page 11 for details.



Experts In Home Cleaning™

©2012 BISSELL Homecare, Inc.
Grand Rapids, Michigan
All rights reserved. Printed in China
Part Number 120-4448
Rev 1/12
Visit our website at:
www.bissell.com

