



Earn BISSELL Rewards!

Register your
product today!

See details on
page 2

POWERease®
WET&DRY
hard floor cleaner

TOTALfloors®
WET&DRY
hard floor cleaner

USER'S GUIDE
5200, 2949 SERIES

- 2 Thank You
- 3 Safety Instructions
- 4 Product View
- 5 Special Features & Assembly
- 6-7 Operations
- 8 Maintenance and Care
- 9 Troubleshooting
- 10 Replacement Parts
- 10 Additional Accessories
- 11 Warranty
- 12 Product Registration
- 12 Consumer Care



Thanks for buying a BISSELL Hard Floor Cleaner

We're glad you purchased a BISSELL PowerEase/Total Floors Wet & Dry Hard Floor Cleaner. Everything we know about floor care went into the design and construction of this complete, high-tech home cleaning system.

Your BISSELL PowerEase/Total Floors Wet & Dry Hard Floor Cleaner is well made, and we back it with a limited two year warranty. We also stand behind it with a knowledgeable, dedicated Consumer Care department, so, should you ever have a problem, you'll receive fast, considerate assistance.

My great-grandfather invented the floor sweeper in 1876. Today, BISSELL is a global leader in the design, manufacture, and service of high quality homecare products like your BISSELL PowerEase/Total Floors Wet & Dry Hard Floor Cleaner.

Thanks again, from all of us at BISSELL.

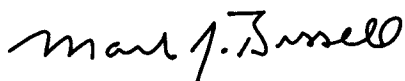

Mark J. Bissell
Chairman & CEO

IMPORTANT SAFETY INSTRUCTIONS

When using an electrical appliance, basic precautions should be observed, including the following:

READ ALL INSTRUCTIONS BEFORE USING YOUR HARD FLOOR CLEANER.

WARNING: To reduce the risk of fire, electric shock, or injury:

- Do not immerse.
- Use only on surfaces moistened by the cleaning process.
- Always connect to a properly grounded outlet.
- See Grounding Instructions.
- Unplug from outlet when not in use and before conducting maintenance or troubleshooting.
- Do not leave machine when it is plugged in.
- Do not service machine when it is plugged in.
- Do not use with damaged cord or plug.
- If appliance is not working as it should, has been dropped, damaged, left outdoors, or dropped into water, have it repaired at an authorized Service Center.
- Use indoors only.
- Do not pull or carry by cord, use cord as a handle, close door on cord, pull cord around sharp corners or edges, run appliance over cord, or expose cord to heated surfaces.
- Unplug by grasping the plug, not the cord.
- Do not handle plug or appliance with wet hands.
- Do not put any object into appliance openings, use with blocked opening, or restrict air flow.
- Do not expose hair, loose clothing, fingers or body parts to openings or moving parts.
- Do not pick up hot or burning objects.
- Do not pick up flammable or combustible materials (lighter fluid, gasoline, kerosene, etc.) or use in the presence of explosive liquids or vapor.
- Do not use appliance in an enclosed space filled with vapors given off by oil base paint, paint thinner, some moth proofing substances, flammable dust, or other explosive or toxic vapors.
- Do not pick up toxic material (chlorine bleach, ammonia, drain cleaner, gasoline, etc.).
- Do not modify the 3-prong grounded plug.
- Do not allow to be used as a toy.
- Do not use for any purpose other than described in this User's Guide.
- Do not unplug by pulling on the cord.
- Use only manufacturer's recommended attachments.
- Use only cleaning products formulated by BISSELL for use in this appliance to prevent internal component damage. See the cleaning fluid section of this guide.
- Keep openings free of dust, lint, hair, etc.
- Do not point attachment nozzle at people or animals
- Keep appliance on a level surface.
- Turn off all controls before unplugging.
- Unplug before attaching the TurboBrush®.
- Be extra careful when cleaning stairs.

- Close attention is necessary when used by or near children.
- Always install float before any wet pick up operation.
- Do not operate the appliance unless the belt door is securely assembled in the location provided.

SAVE THESE INSTRUCTIONS.

THIS MODEL IS FOR HOUSEHOLD USE ONLY.

GROUNDING INSTRUCTIONS

This appliance must be connected to a grounded wiring system. If it should malfunction or break down, grounding provides a safe path of least resistance for electrical current, reducing the risk of electrical shock. The cord for this appliance has an equipment-grounding conductor and a grounding plug. It must only be plugged into an outlet that is properly installed and grounded in accordance with all local codes and ordinances.

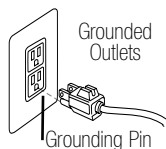

WARNING:

Improper connection of the equipment-grounding conductor can result in a risk of electrical shock. Check with a qualified electrician or service person if you aren't sure if the outlet is properly grounded. **DO NOT MODIFY THE PLUG.** If it will not fit the outlet, have a proper outlet installed by a qualified electrician. This appliance is designed for use on a nominal 120-volt circuit, and has a grounding attachment plug that looks like the plug in the drawing above. Make certain that the appliance is connected to an outlet having the same configuration as the plug. No plug adapter should be used with this appliance.

Product view



WARNING:

Do not over wet the floor. Apply solution by depressing the trigger on the forward stroke only and release the trigger on the rearward stroke. Over wetting the floor surface may cause delamination of certain laminated flooring materials.

Special Features

The following Specialized Cleaning Accessories are included with the purchase of your PowerEase/Total Floors Wet & Dry Hard Floor Cleaner:

The PowerEase/Total Floors Wet & Dry Hard Floor Cleaner was designed to give the user the ability to easily change between the Gentle Clean™ Brushes and Pads.

1. **The Gentle Clean™ Brush** is recommended for use on Hard Floor surfaces such as tile, vinyl, or surfaces that have grout or crevices where dirt and grime collect.
2. **The Gentle Clean™ Pad** is intended for use on more delicate surfaces such as sealed hardwood, laminates or vinyl.
3. **The Pleated Filter**, located in the lid of the Collection Tank should be cleaned periodically.

To replace, visit www.BISSELL.com

Assembly

Assembling your new BISSELL PowerEase/Total Floors Wet & Dry Hard Floor Cleaner is a simple 2-Step Process:

NOTE: Remove Solution Tank from unit first.

1. Insert the Handle into the top of the unit, making sure the Spray Trigger is on the Wet Vacuum side. Make sure the screw opening in the handle is aligned with the hole in the housing of the unit.
2. Insert screw; gently screw in until tight with the body of the unit.

WARNING:

Do not plug in your cleaner until you have completely assembled it per the following instructions and are familiar with all instructions and operating procedures.



WARNING:

To reduce the risk of fire, use only BISSELL Hard and Wood Floor Cleaning Solutions in your PowerEase/Total Floors Wet & Dry Hard Floor Cleaner. Use of cleaning formulas which contain lemon or pine oil may damage this appliance and void the warranty. Chemical spot cleaners or solvent based soil removers should not be used. These products may react with the plastic materials used in your floor cleaner causing cracking or pitting.

Operations

How To Use Your PowerEase/Total Floors Wet & Dry Hard Floor Cleaner

1. Remove the Solution Tank from the machine.
2. Unscrew the black cap on the bottom of the solution tank and remove the insert.
3. **Filling the Solution Tank:** Fill with BISSELL Formula to the formula fill line and fill with water to the Water Line. Replace the Cap & Insert Assembly. Place the full tank back into the unit.

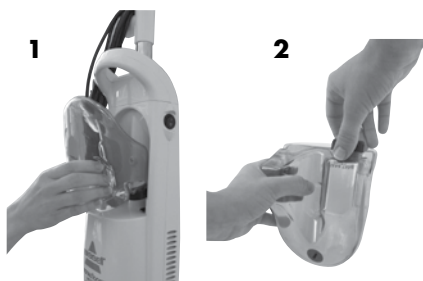

Inserting The Gentle Clean™ Brush or Pad

The first time you use your unit, the Gentle Clean™ Pad will be in the unit. Based on your flooring type and personal preference, you may want to change to the Gentle Clean™ Brush. To change pad or brush, pull out sideways.

Cleaning Fluid Section

Keep plenty of genuine BISSELL Hard and Wood Floor Cleaning Solutions on hand so you can clean when it fits your schedule. Always use genuine BISSELL cleaning formulas.

16 oz.
56L9



16 oz.
81T7



Tip:

Use only specially formulated BISSELL Hard Floor and Wood Floor Solutions formula. Non-BISSELL cleaning formulas may harm the machine and void the warranty.

WARNING:

To Reduce the Risk of Fire and Electric Shock due to internal component damage, use only BISSELL cleaning fluids intended for use with the hard floor cleaner.



Tip:

When plugging the unit in, make sure to hook the power cord into the Cord Clip. This will help guide the power cord when you flip from Dry to Wet Cleaning.

Tip:

When using a Dry Gentle Clean™ Pad, you may want to get it slightly damp by squeezing the trigger to saturate the pad. This will aid in the flow of water and formula to clean sticky grime and spots.

Operations

Dry Vacuuming

With the Dry Side of the unit facing forward, turn the unit on and begin cleaning.

You will see dry dirt, crumbs and debris being collected in the Collection Tank. You do not have to empty the dry debris before wet cleaning.

Flipping From Dry to Wet Cleaning

To change from dry vacuuming to wet cleaning simply flip the unit around!

The Gentle Clean™ Brush or Pad and Squeegee will automatically be lowered to effectively clean and dry all your Hard Floor Surfaces.

Wet Cleaning/Vacuuming

To begin Wet Cleaning, simply depress the Spray Trigger. Water and Formula will be dispensed through the Gentle Clean™ Brush or Pad.

To maximize the area to be cleaned, depress the Spray Trigger on the forward stroke and release on the reverse stroke.

This will dispense water and formula going forward and on the pull back, the squeegee will leave the floor essentially dry and ready to walk on.

Collection Tank is Full

While Wet Cleaning, you will see dirty water collected in the Collection Tank. When the Tank is full, the white Float in the Collection Tank will rise to the top, making a noticeable sound to let you know it is time to empty the Collection Tank. Suction will stop when tank is full of water.

Tip:

To extend the life of your filter and to maintain maximum dry suction, check the filter for lint and debris frequently.



Tip:

To make sure water and formula are flowing, depress the Spray Trigger without the Gentle Clean™ Brush or Pad Inserted. You should see a light stream of water and formula dispensed unto the floor.

Maintenance and care

Emptying The Collection Tank

Remove the Collection Tank Lid. Then dump the dirty water and debris into the sink, toilet, laundry tub or outside. Rinse the tank out with warm water and replace it in the unit.

Checking The Filter

While the Collection Tank is out of the unit, remove the Pleated Filter from the top of the tank. Remove dirt and debris from the pleats by gently tapping the filter over the wastebasket or outside.

The Pleated Filter can also be rinsed under water to clean.

NOTE: If the Pleated Filter is rinsed with warm water to clean, it is recommended to leave it out of the unit to air dry before placing it back in the unit.

Visit www.BISSELL.com for replacement parts.

Cleaning The Gentle Clean™ Brush or Pad

Gentle Clean™ Brush

Remove the Brush from the unit and rinse under warm water.

Gentle Clean™ Pad

Remove the Gentle Clean™ Pad Plate from the unit. Peel the pad from the Pad Plate and toss in the wash!

Removing Wet Clean Nozzle

Remove the Wet Clean Nozzle by pulling tab on right and left side of nozzle. Rinse any dirt and grime off the nozzle under warm tap water.

To replace the Wet Clean Nozzle, insert the 4 tabs along the bottom of the Nozzle Window and gently snap the Wet Cleaning Nozzle back into place.

Storing Your Hard Floor Cleaner

Your PowerEase/Total Floors Wet & Dry Hard Floor Cleaner can be stored Ready-to-Use, by leaving water and formula in the unit. Be sure to remove wet Gentle Clean™ Pad before storing.

Tip:

While using the PowerEase / Total Floors Wet & Dry Hard Floor Cleaner in the Wet Cleaning mode, make sure to listen for the change in the sound to alert you when the Collection Tank is full.

Tip:

If there are large pieces of debris in the water, you may not want to empty the tank into your sink.

WARNING:

To reduce the risk of fire, electric shock or injury unplug from outlet before servicing.



Tip:

If the Pleated Filter is rinsed with warm water to clean, it is recommended to leave it out of the unit to air dry before placing it back in the unit.

Troubleshooting

Water & Formula are draining out from the solution tank.

Possible Causes

1. Solution Tank Black Cap & Valve are not on tight
2. Solution Tank Black Cap & Valve are cross threaded

No suction

Possible Causes

1. Filter may be dirty or clogged
2. Wet vacuum nozzle may not be on properly
3. Tank is full
4. Filter is wet
5. Something is caught and clogging the air path

Water is not flowing

Possible Causes

1. Solution Tank is not inserted properly

Other maintenance or service not included in the manual should be performed by an authorized service representative.

Thank you for selecting a BISSELL product.

Please do not return this product to the store.

For any questions or concerns, BISSELL is happy to be of service. Contact us directly at 1-800-237-7691.

WARNING:

To reduce the risk of fire, electric shock or injury unplug from outlet before servicing.

Remedies

1. Remove Black Cap & Valve and attach tightly
2. Remove Black Cap & Valve and make sure it is screwed on straight and tightly

Remedies

1. Remove filter from the Collection Tank and clean
2. Make sure Wet Vacuum Nozzle is on tight and snapped into place
3. Empty Tank
4. Make sure filter is completely dry before placing back into the unit.
5. Unplug unit. Remove Wet Clean Nozzle and insert a blunt object into the air path to remove any potential clog.

Remedies

1. Remove Tank and reinsert into the unit

Replacement parts

Item	Part No.	Part Name
1	203-6705	Filter
2	203-8377	Collection Tank Lid Assembly – Black
3	203-8372	Collection Tank Lid Assembly – White
4	203-8371	Collection Tank
5	203-8373	Wet Vacuum Nozzle
6	203-8370	Solution Tank with Cap
7	203-8375	Handle with Screw – Black
8	203-8368	Handle with Screw – White
9	203-6800	Cap and Insert Assembly
10	203-8376	Cord Wrap – Black
11	203-8369	Cord Wrap – White

*Not all parts are included with every model.

Additional Accessories

Item	Part No.	Part Name
1	203-6700	Gentle Clean™ Brush Card
2	203-6701	Gentle Clean™ Pad Card
3	203-8374	Gentle Clean™ Pad (2 pack)
4	3270	Replacement Pack (2 Gentle Clean™ Pads & 1 Pleated Filter)
5	81T7	2X Wood Floor Solutions
6	56L9	2X Hard Floor Solutions

1



2



3



4



5



6



Warranty

This warranty gives you specific legal rights, and you may also have other rights which may vary from state to state. If you need additional instruction regarding this warranty or have questions regarding what it may cover, please contact BISSELL Consumer Care by E-mail, telephone, or regular mail as described below.

Limited Two Year Warranty

Subject to the *EXCEPTIONS AND EXCLUSIONS identified below, upon receipt of the product BISSELL will repair or replace (with new or remanufactured components or products), at BISSELL's option, free of charge from the date of purchase by the original purchaser, for two years any defective or malfunctioning part.

See information below on "If your BISSELL product should require service".

This warranty applies to product used for personal, and not commercial or rental service. This warranty does not apply to routine maintenance components such as mop pads. Damage or malfunction caused by negligence, abuse, neglect, unauthorized repair, or any other use not in accordance with the product's use instructions is not covered.

If your BISSELL product should require service:

Contact BISSELL Consumer Care to locate a BISSELL Authorized Service Center in your area.

If you need information about repairs or replacement parts, or if you have questions about your warranty, contact BISSELL Consumer Care.

Website or E-mail:

www.bissell.com

Or Call:

BISSELL Consumer Care

1-800-237-7691

Monday - Friday 8 am - 10 pm ET

Saturday 9 am - 8 pm ET

Or Write:

BISSELL Homecare, Inc.

PO Box 3606

Grand Rapids, MI 49501

ATTN: Consumer Care

BISSELL IS NOT LIABLE FOR INCIDENTAL OR CONSEQUENTIAL DAMAGES OF ANY NATURE ASSOCIATED WITH THE USE OF THIS PRODUCT. BISSELL'S LIABILITY WILL NOT EXCEED THE PURCHASE PRICE OF THE PRODUCT.

Some states do not allow the exclusion or limitation of incidental or consequential damages, so the above limitation or exclusion may not apply to you.

*EXCEPTIONS AND EXCLUSIONS FROM THE TERMS OF THE LIMITED WARRANTY

THIS WARRANTY IS EXCLUSIVE AND IN LIEU OF ANY OTHER WARRANTIES EITHER ORAL OR WRITTEN. ANY IMPLIED WARRANTIES WHICH MAY ARISE BY OPERATION OF LAW, INCLUDING THE IMPLIED WARRANTIES OF MERCHANTABILITY AND FITNESS FOR A PARTICULAR PURPOSE, ARE LIMITED TO THE TWO YEAR DURATION FROM THE DATE OF PURCHASE AS DESCRIBED ABOVE.

Some states do not allow limitations on how long an implied warranty last so the above limitation may not apply to you.

NOTE: Please keep your original sales receipt. It provides proof of date of purchase in the event of a warranty claim.

Don't forget to register your product!

Registering is quick, easy and allows us to serve you better over the lifetime of your product. You'll receive:

BISSELL Reward Points

Automatically earn points for discounts and free shipping on future purchases.

Efficient Service

Supplying your information now saves you time should you need to contact us with questions regarding your product.

Product Support Alerts

We'll contact you with any important product alerts.

Special Promotions

Optional: Register your email to receive notice of offers, contests, cleaning tips and more!

Visit bissell.com/registration now!

BISSELL consumer care

For information about repairs or replacement parts, or questions about your warranty, call:

BISSELL Consumer Care
1-800-237-7691

Monday - Friday 8 am — 10 pm ET

Saturday 9 am — 8 pm ET

Or write:

BISSELL Homecare, Inc.

PO Box 3606

Grand Rapids MI 49501

ATTN: Consumer Care

Or visit the BISSELL website - **www.bissell.com**

When contacting BISSELL, have model number of cleaner available.

Please record your Model Number: _____

Please record your Purchase Date: _____

NOTE: Please keep your original sales receipt. It provides proof of purchase date in the event of a warranty claim. See Warranty on pages 11 for details.



©2012 BISSELL Homecare, Inc.
Grand Rapids, Michigan
All rights reserved. Printed in China
Part Number 110-4484
Rev 6/12
Visit our website at:
www.bissell.com

