

HOOVER[®]

Commercial Shoulder Vac[™] Cleaner

Owner's Manual

ENGLISH → pp. 1-9

ESPAÑOL → pág. 10-14

FRANÇAIS → p. 15-19

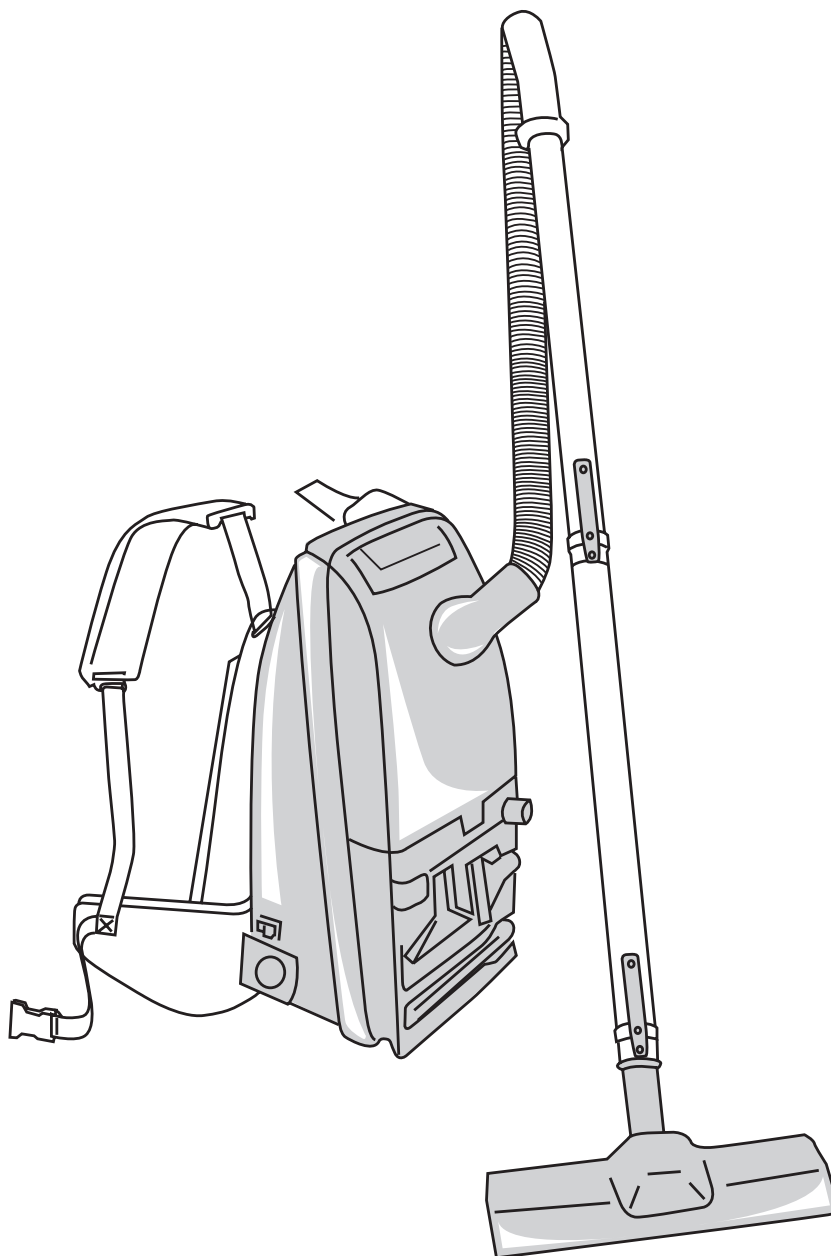

**Review this manual before
operating cleaner**



www.hoover.com

Fill in and retain

The model and serial number are located on the bottom of the cleaner.

Model number _____

Serial number _____

It is suggested that you attach your sales receipt to this owner's manual. Verification of date of purchase may be required for warranty service of your Hoover product.

Index

Assembling Cleaner	3-5
How To Use	
Cleaner Descriptions	5
Cleaning Tools	6
Rug and Floor Nozzle	6
If You Have a Problem	8
Clearing Blockages	9
Important Safeguards	2
Maintenance	
Filter Bag	7
Lubrication	8
Rug and Floor Nozzle	6
Secondary Filter	8
Service	8



DOUBLE INSULATED: When servicing, use only identical replacement parts.

This cleaner meets Occupational Safety and Health Act (OSHA-29 CFR 1910 Subpart S) requirements.

© 2003 The Hoover Company
www.hoover.com

Important Safeguards

When using an electrical appliance, always follow basic precautions, including the following:

READ ALL INSTRUCTIONS BEFORE USING THIS APPLIANCE

Warning:

To reduce the risk of fire, electric shock or injury:

- Do not use outdoors or on wet surfaces.
- This appliance is provided with double insulation. Use only identical replacement parts. See instructions for servicing double-insulated appliances.
- Close supervision is necessary when any appliance is used by or near children. Do not allow vacuum cleaner to be used as a toy or to run unattended at any time.
- Keep hair, loose clothing, fingers, and all parts of body away from openings and other moving parts. Do not operate cleaner in bare feet or when wearing open toe shoes or sandals.
- Do not pick up anything that is burning or smoking, such as cigarettes, matches, or hot ashes.
- Do not use to pick up flammable or combustible liquids such as gasoline or fine wood sandings or use in areas where they may be present.
- Avoid picking up hard, sharp objects with the cleaner. They may damage the cleaner and the bag.
- Do not use without dust bag or filters in place. Change bag frequently when picking up very fine materials such as powder.
- Use extra care when cleaning on stairs.
- Do not put any object into openings. Do not use with any opening blocked; keep free of dust, lint, hair, or anything that may reduce air flow.
- Do not pull or carry by cord, use cord as a handle, close door on cord or pull cord around sharp edges or corners. Do not run appliance over cord. Keep cord away from heated surfaces.
- Always disconnect cord from electrical outlet before servicing the cleaner.
- Unplug cleaner when not in use. Turn off all controls before unplugging.
- Do not unplug by pulling on cord. To unplug, grasp the plug, not the cord. Never handle plug or appliance with wet hands.
- The use of an extension cord is not recommended. If an extension cord is absolutely necessary, use at least a 16 gauge 3-wire cord which has a 3-prong plug and a 3-pole receptacle that accepts the machine plug.
- Do not use with damaged cord or plug. If appliance is not working as it should, has been dropped, damaged, left outdoors, or dropped into water, take it to a Hoover Factory Service Center or Authorized Hoover Warranty Service Dealer (Depot).
- Use vacuum cleaner only for its intended use as described in the instructions. Use only attachments recommended by The Hoover Company; others may cause hazards.

Save these instructions!

1. Assembling cleaner

Carton contents

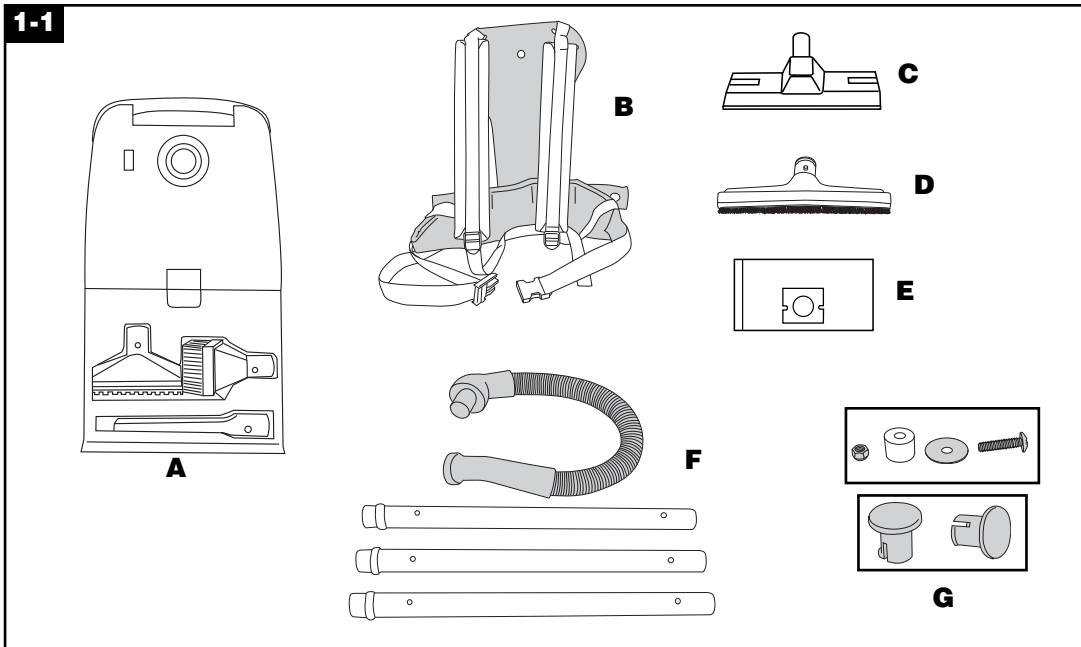

Unpack cleaner from carton and identify the parts shown. Make sure all parts, especially small items such as "G", are located before disposing of cardboard packing.

- A. Canister cleaner
- B. Shoulder harness
- C. Rug and floor nozzle
- D. Wall/floor brush
- E. Cloth bag (installed in cleaner)
- F. Extension wands and hose
- G. Hardware for harness installation (2 packets)

Assembling cleaner

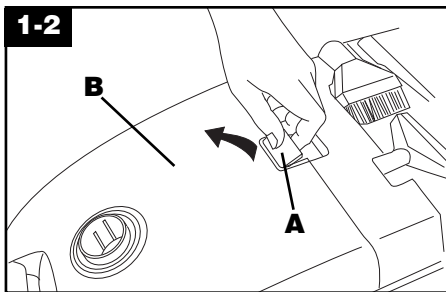

Attach harness

Lift bag latch (A) and open bag lid (B).

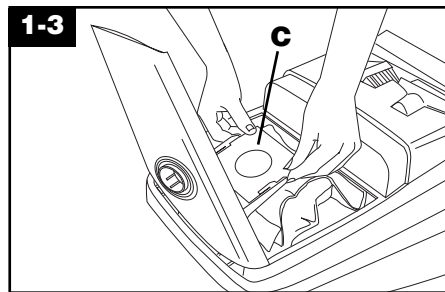

Grasp bag collar (C) and pull out to remove cloth bag. The bag lid and hinges are designed with a "break-away" feature. If the lid is pushed open too far, it will come off and can easily be replaced when assembly is complete (see Fig. 1-10).

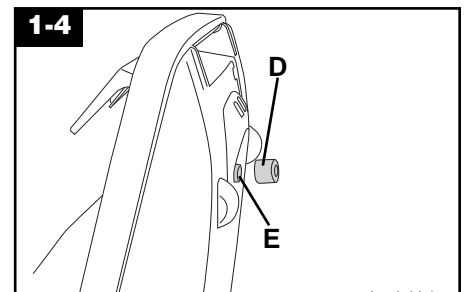

Stand cleaner on end. Locate larger hole in spacer (D) and fit it over hole in bottom of cleaner (E).

Continued →

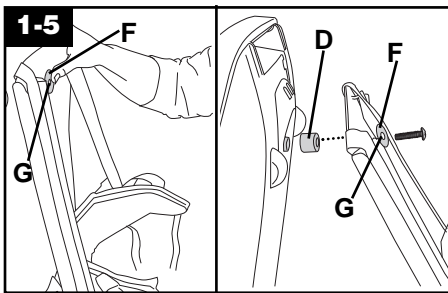

With padded section of harness facing out and down as shown, position washer (F) over top hole (G) on harness. Insert screw through washer (F), harness (G), and spacer (D).

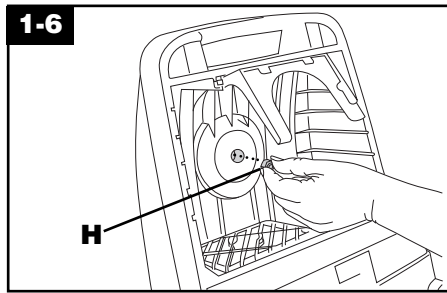

Holding nut (H) in place, tighten screw with a screwdriver.

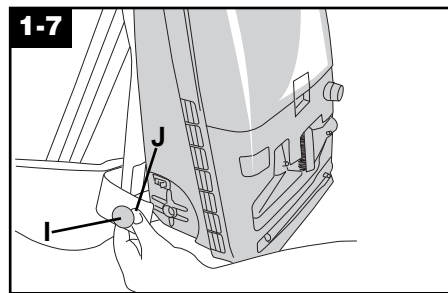

Push the two black harness attachment snaps (I) through the hole (J) on either side of the harness.

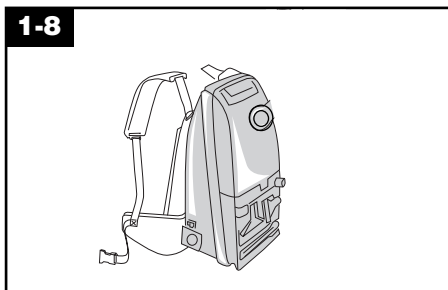

Snap the harness attachment snaps into the holes in the cleaner body. **Extra effort may be required to snap into cleaner body.**

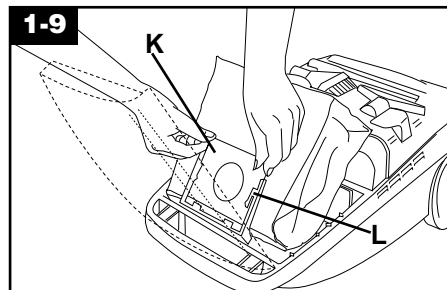

Lay cleaner flat. Slide bag collar (K) into collar bracket (L). Fit sides of bag into bag compartment.

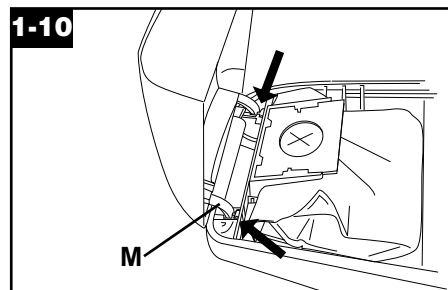

If the bag lid has come off, align the hinges (M) with the appropriate slots in the cleaner as shown and snap in place. Close lid.

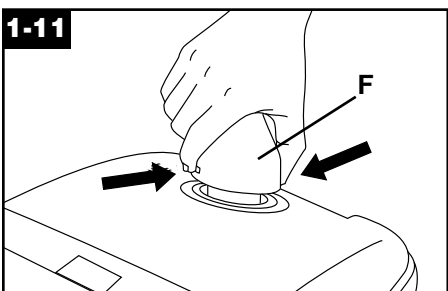

Connect hose

With hose toward front of cleaner, push hose connector (F) into opening in bag lid. To disconnect hose, depress buttons on hose connector and pull up.

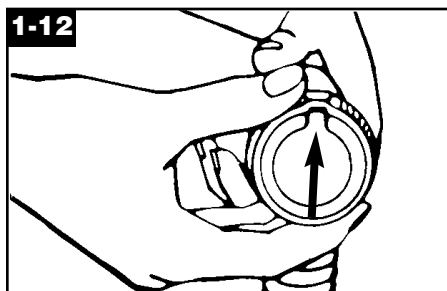

Attach wands, tools and nozzle

To attach hose to an extension wand or tool, turn plastic latch ring on hand grip until outer slot lines up with inner slot.

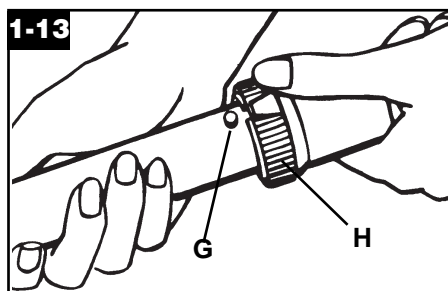

Slide button (G) on wand or tool into slot on grip. Turn latch ring (H) to lock in place.

1-14

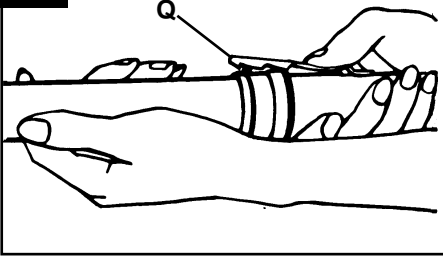

Attach metal wand or tool by pushing the button on one into the spring latch (Q) of the other.

To remove, press down on center of latch and pull out.

2. How to use

Cleaner description

2-1

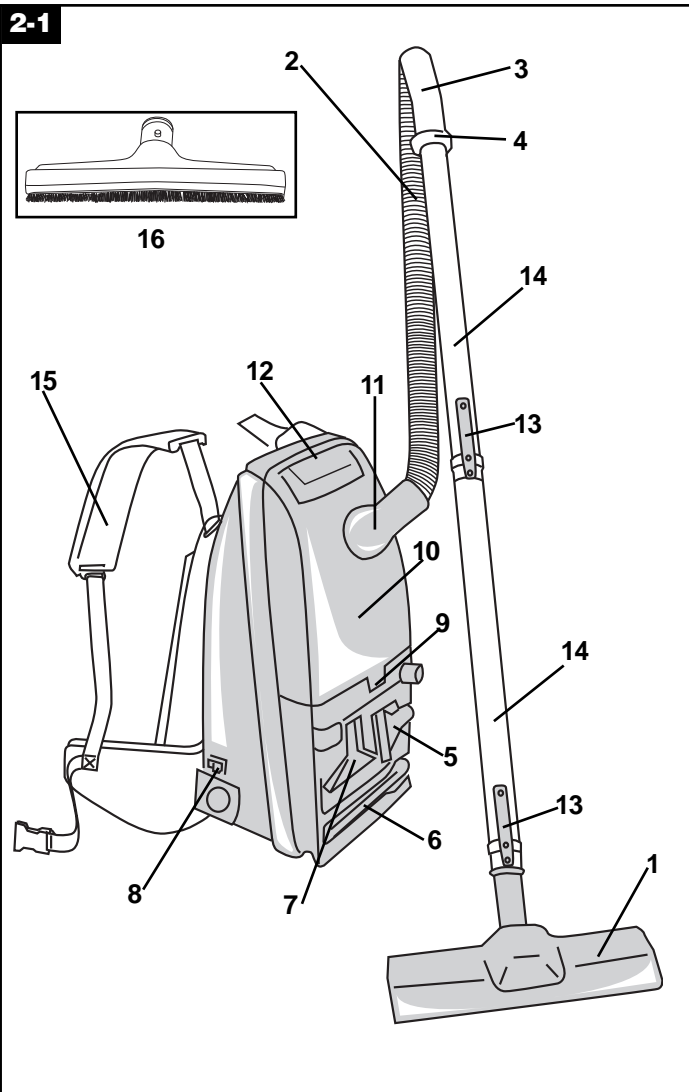

The assembled cleaner will look like the drawing.

1. Rug and floor nozzle
2. Hose
3. Hand grip
4. Plastic latch ring: located on hand grip; rotate to lock wands and cleaning tools to hose.
5. Dusting brush
6. Crevice tool
7. Furniture nozzle
8. ON-OFF switch
9. Bag lid latch: lift to open bag lid.
10. Bag lid
11. Hose connector
12. Carrying handle
13. Spring latch on metal wands: locks extension wands together or locks wand to nozzle or tool.
14. Extension wands: used with rug and floor nozzle. One or more wands may be used with cleaning tools.
15. Shoulder harness
16. Wall/floor brush

Operate cleaner only at voltage specified on data plate on bottom of cleaner.

Continued →

CAUTION: POTENTIAL SHOCK HAZARD
 This vacuum cleaner is not intended to be used where water may be present. Carpet will retain moisture long after it has been wet. This vacuum cleaner should not be used on wet or moist carpet.

Polarized plug

To reduce the risk of electric shock, this appliance has a polarized plug (one blade is wider than the other). This plug will fit in a polarized outlet only one way. If the plug does not fit fully in the outlet, reverse the plug. If it still does not fit, contact a qualified electrician to install the proper outlet. **Do not change the plug in any way.**

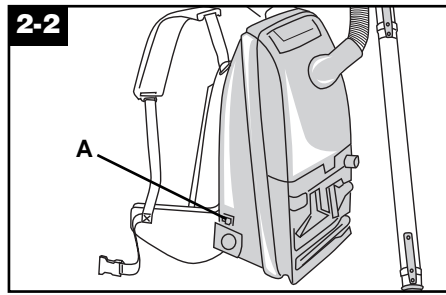

ON-OFF switch

The ON-OFF switch (A) is located on the side of the cleaner. Plug cord into an electrical outlet.



Adjust straps

Adjust the shoulder straps so that the cleaner fits high and snug on the back. This should provide a comfortable fit for usage. Snap both sides of the waist strap together. If necessary, minor adjustments may be made for comfort.

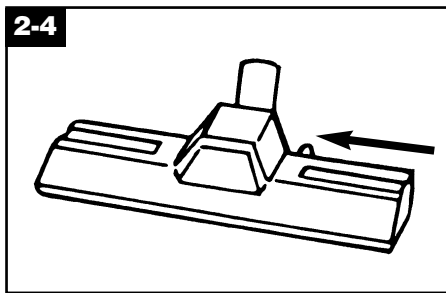

Rug and floor nozzle

The combination rug and floor nozzle has been designed to do an efficient cleaning job on both carpet and hard surface floors. For most efficient cleaning, place nozzle flat on surface being cleaned.

Hard surface floors

Lock brushes to clean bare floors by sliding indicator toward BARE FLOOR.

Rugs

Release brushes to clean carpet by sliding indicator toward RUG.

Cleaning tools

The cleaning tools have many uses. Select the tool best suited for the cleaning task from the descriptions below.

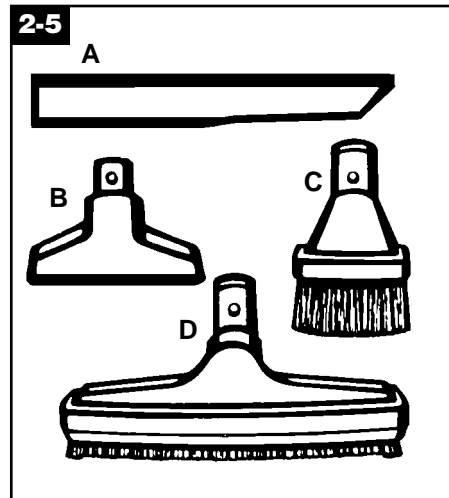

Selecting tools

- A. Crevice tool** may be used in tight spaces, corners and along edges in such places as dresser drawers, upholstered furniture, stairs and baseboards.
- B. Furniture nozzle** may be used for upholstered furniture, draperies, tapestries, mattresses, clothing, automobile interiors and carpeted stairs.
- C. Dusting brush** may be used for carved furniture, table tops, books, lamps, lighting fixtures, venetian blinds, baseboards, shutters and registers.
- D. Wall/floor brush** may be used for walls and very irregular hard surface floors such as brick and slate.



Attaching tools

Attach tools to hand grip by rotating latch ring until slots align; insert tool and rotate ring to lock.

To remove tool, reverse above procedure.

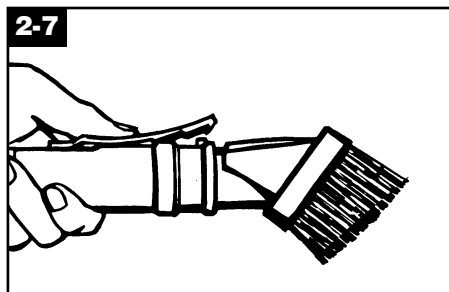

Attach tools to metal wand by pushing button projection on tool into spring latch on wand.

Depress center of latch to remove.

3. Maintenance

Disconnect cleaner from electrical outlet before attempting to service it in any manner.

The bag

Check bag from time to time and empty when necessary.

CAUTION: Very fine materials in large quantities such as face powder, cornstarch, fireplace ashes or fireplace soot, may seal the pores of the bag. When the cleaner is used to remove material of this nature, empty the bag frequently. Never operate cleaner without the bag.

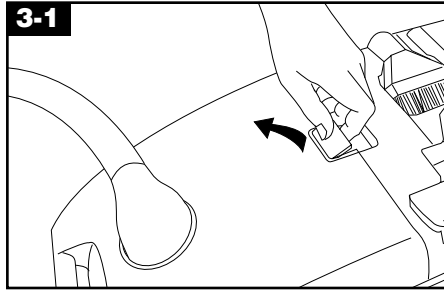

To empty bag

Disconnect cleaner from electrical outlet.

Rotate hose to the side, lift bag latch and open bag lid.

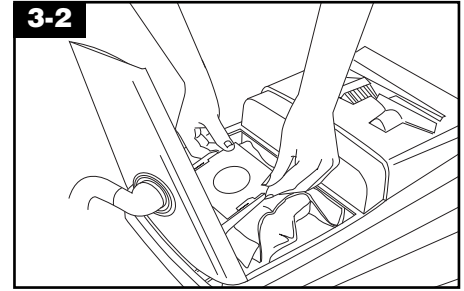

Carefully pull bag out.

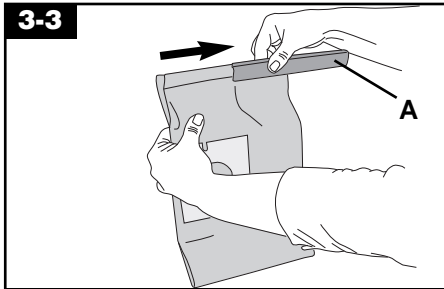

Hold bag over waste can and slide bag clamp (A) from bottom of bag.

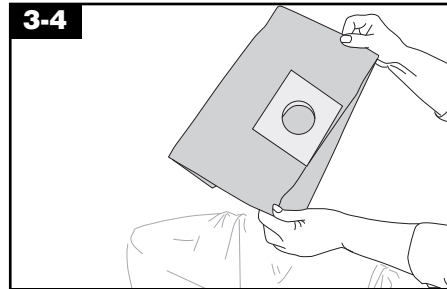

Shake bag until clean.

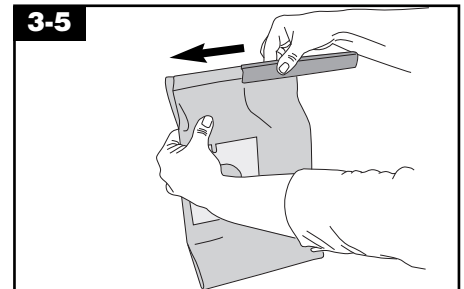

Replace bag clamp.
Replace cloth bag (Fig. 1-9). Close lid.

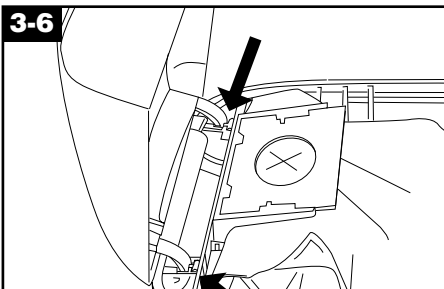

Re-attaching bag lid

The bag lid and hinges are designed with a "break away" feature. If the lid is pushed open too far, it will come off. It can easily be re-attached by aligning the hinges with the appropriate slots in the cleaner as shown.

Optional paper throw away bag

A HOOVER® Type S paper throw away bag, available from your Authorized Hoover Warranty Service Dealer (Depot), may be used with this cleaner in place of the reusable cloth bag. Remove cloth bag and install the paper bag in the same manner.

Continued →

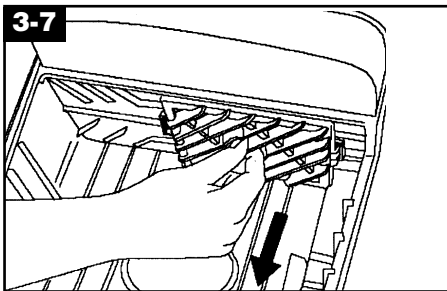

Secondary filter Cleaning filter

Disconnect cleaner from electrical outlet.

The secondary filter, located behind the grill in the bag compartment, protects the motor from dirt particles. If filter becomes dirty, pull off grill and lift out filter. Wash filter in warm water or replace it with a new one. A **dry** filter must be put back into cleaner.

Do not operate cleaner without secondary filter in place.

Rug and floor nozzle

To maintain cleaning effectiveness of your rug and floor nozzle, the brushes may need to be replaced occasionally. See your nearest Hoover Factory Service Center or Authorized Warranty Service Dealer (Depot) for new brushes.

Lubrication

The motor is equipped with two bearings that contain sufficient lubrication for the life of the motor. The addition of lubricant could cause damage. **Therefore, do not add lubricant to the motor bearings.**

Thermal protector

An internal thermal protector has been used in your cleaner to prevent overheating if a large item or clog gets caught in the nozzle or at the opening of the bag.

When the blockage is not removed, the thermal protector will trip and the cleaner will stop running. If this happens, turn cleaner OFF and **disconnect cleaner from electrical outlet.** Then disconnect nozzle to remove obstruction. Within 15 minutes, the thermal protector will cool and automatically reset and cleaning may resume. If cleaner does not operate, allow additional time for the thermal protector to reset.

Service

To obtain approved HOOVER service and genuine HOOVER parts, locate the nearest **Hoover Factory Service Center or Authorized Hoover Warranty Service Dealer (Depot)** by:

- checking the Yellow Pages under "Vacuum Cleaners - Industrial or Commercial" OR -
- checking the list of Factory Service Centers provided with this cleaner OR -
- checking the Service section of The Hoover Company online at **www.hoover.com** OR -
- calling 1-800-944-9200 for an automated referral of authorized service outlet locations (U.S. only).

Please do not send your cleaner to The Hoover Company in North Canton for service, this will only result in delay. If further assistance is needed, contact The Hoover Company Consumer Response Center, North Canton, Ohio 44720, Phone: 330-499-9499.

In Canada, contact Hoover Canada, Burlington, Ontario L7R 4A8, Phone: 1-800-263-6376.

Always identify your cleaner by the **complete** model number when requesting information or ordering parts. (The model number appears on the bottom of the cleaner.)

Servicing of double-insulated appliances

This vacuum cleaner is double insulated. In a double-insulated appliance, two systems of insulation are provided instead of grounding. No grounding means is provided on a double-insulated appliance, nor should a means for grounding be added. Servicing a double-insulated appliance requires extreme care and knowledge of the system, and should be done only by qualified service personnel. **Replacement parts must be identical to those parts being replaced.** A double-insulated appliance is marked with the words "DOUBLE-INSULATION" or "DOUBLE-INSULATED".

The symbol  may also be marked on the appliance.

4. If you have a problem

If a minor problem occurs, it usually can be solved quite easily when the cause is found by using the check list below.

Problem: Cleaner won't run

Possible cause

Possible solution

- **Not firmly plugged in**
- *Plug in firmly*
- **No voltage in wall plug**
- *Check fuse or breaker*
- **Blown fuse/tripped breaker**
- *Replace fuse/reset breaker*
- **Thermal protector tripped**
- *Remove obstruction/empty bag/change paper bag (see "The bag" section)*

Problem: Cleaner won't pick up

Possible cause

Possible solution

- **Bag full**
- *Empty bag/change paper filter bag*
- **Paper filter bag not opening**
- *Open bag by pulling folds*
- **Blockage in nozzle,hose or attachments**
- *Remove blockage (see "Clearing blockages" section)*
- **Secondary filter dirty**
- *Clean or replace filter*

Problem: Nozzle won't pick up

Possible cause

Possible solution

- **Nozzle brush worn**
- *Replace brush*

Clearing blockages

Remove larger items from carpet and other surfaces before vacuuming to help prevent blockages in hose, wands or nozzle connector, and to maintain cleaning effectiveness of your cleaner.

To check for blockages, proceed with each of the following steps until the blockage is found.

1. **Turn cleaner OFF and disconnect wands from hand grip.**

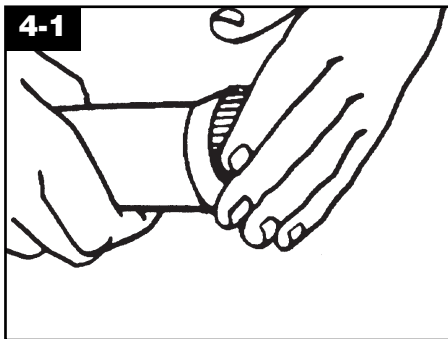

2. Turn cleaner ON and check hose end for suction. Turn cleaner OFF and remove any blockages.

3. Remove nozzle from wands and attach wands to hose. Turn cleaner ON and check for suction.

Turn cleaner OFF and remove any blockages.

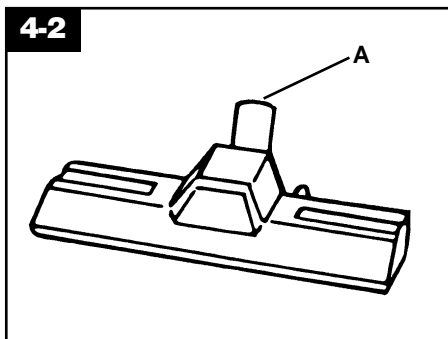

4. Before attaching nozzle to wands, check nozzle connector (A).

Look into nozzle connector and remove any blockages.