





Trilobiter, en klass leddjur som levde för ca 250–560 miljoner år sedan. Många levde av att dammsuga havsbotten på smådjur och partiklar. Ryggsidan var hård och är den kanske mest kända av de fossiler du kan se i väggar, trappor och golv av sten. Detta urgamla djur är inspirationskälla till Trilobites futuristiska design.

Trilobite – a class of arthropods that lived on earth about 250-560 million years ago. Many received nourishment by vacuuming the ocean beds for small animals and particles. Their backs were hard, and they are perhaps the most well known fossils we know today, and can often be observed embedded in stone in walls, staircases and floors. This ancient creature has served as a source of inspiration for the futuristic design of Trilobite.

Svenska

Innehållsförteckning

Dags att njuta av livet	2-3
Funktionsbeskrivning	4-5
Säkerhet	6-7
Förberedelser	8-9
Knappar och display	10
Städprogram	11
Timer	12
Välja språk	12
Felmeddelanden	12
Frågor och svar	13
Tömning/rengöring av filterkassett	14-15
Valsrengöring	14-15
Tillbehör/Konsumentinformation	16
Tekniska data	17

English

Table of Contents

Time to Enjoy Life	18-19
Functional Description	20-21
For Your Own Safety	22-23
Preparations Before Use	24-25
Buttons and Display	26
Vacuuming Programmes	27
Timer	28
Changing the Message Display Language	28
Status Messages	28
Questions and Answers	29
Emptying and Cleaning the Dust Collector	30-31
Cleaning the Roller	30-31
Accessories/After-Sales Service	32
Technical Specifications	33



“I am Trilobite – your personal vacuum cleaner. I do the vacuuming so you can do other things”

Time to enjoy life

Let me take the strain out of cleaning. Just leave me on the floor. I will vacuum for you. Automatically. My built-in, advanced sensors scan the room when I vacuum. I charge myself and switch off when the job is done. Just leave me to do the job.

Let me vacuum the kitchen when you are surfing the net in the other room. And I will take care of the room when you cook in the kitchen. Let me vacuum a room each day when you go to work. I will take care of spilled rice and sugar. I am Trilobite – your personal vacuum cleaner. I do the vacuuming so you can do other things, as often as you want, and without taking up your time.

Of course you're impatient and want to switch me on right away. No problem. All you need to do is to:

1. Charge me as shown on page 24.
2. Place me as shown on page 20.
3. Press the start button, Ⓢ (upper right button).
4. Confirm by pressing the YES button (lower right button).

But before starting, read the precautions on page 22-23!

 **Electrolux**

Functional Description

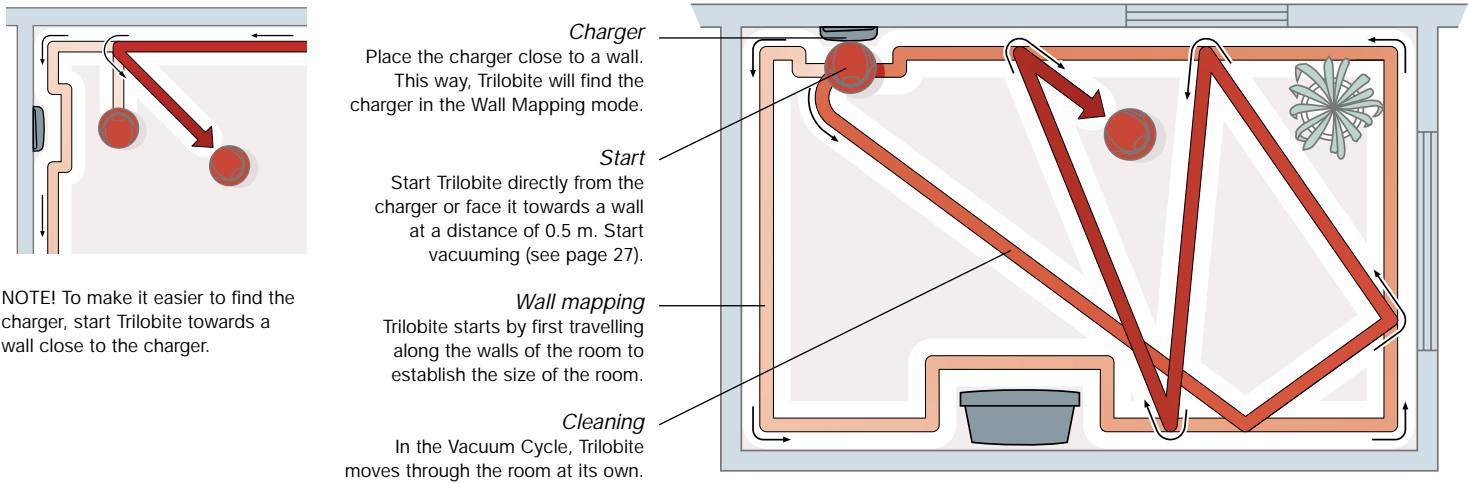

Vacuum programmes

Trilobite has three vacuum programmes:

- “Normal” Trilobite first plots the room by following the walls (wall mapping) and then vacuums all open surfaces.
- “Quick” The same as Normal, however without Wall Mapping.
- “Spot” Trilobite vacuums an area of about one square metre twice.

Refer to page 27 for more information on how to proceed and when to use the different programmes.

Starting vacuuming

You will probably use the Normal programme most of the time. This programme starts with Trilobite approaching a wall and then mapping the walls in the room by left turns. Trilobite first travels one full circumference of the room continually turning left. Depending on the size and layout of the room, wall mapping may last for up to 15 minutes (25 minutes if it has found the charger). After this, Wall Mapping ends, and vacuuming commences.

Main cleaning program

During the main cleaning sequence, Trilobite moves freely all over the room. Trilobite “sees” its way around with the help of harmless ultrasound. This is the same technique that is used by bats for navigation in the dark, for instance, and for foetal diagnosis in hospitals. When it discovers an object in its path, Trilobite stops a few centimetres in front of it and then changes direction. Trilobite can handle most obstacles. However, if it gets stuck, it will continue with its cleaning program if you release it within 20 minutes, put it back down on the floor within 30 seconds and press the “Continue Cleaning” button.

Charging

If Trilobite locates the charger during Wall Mapping (or by chance during Quick vacuuming), it will return to the charger unit whenever the battery charge falls below a specific level. Once the batteries have been charged, Trilobite goes to work again until the room has been vacuumed. When the work is done, Trilobite returns to the charger.

If Trilobite cannot find the charger during Wall Mapping and the battery voltage becomes too low, it will stop somewhere in the room.

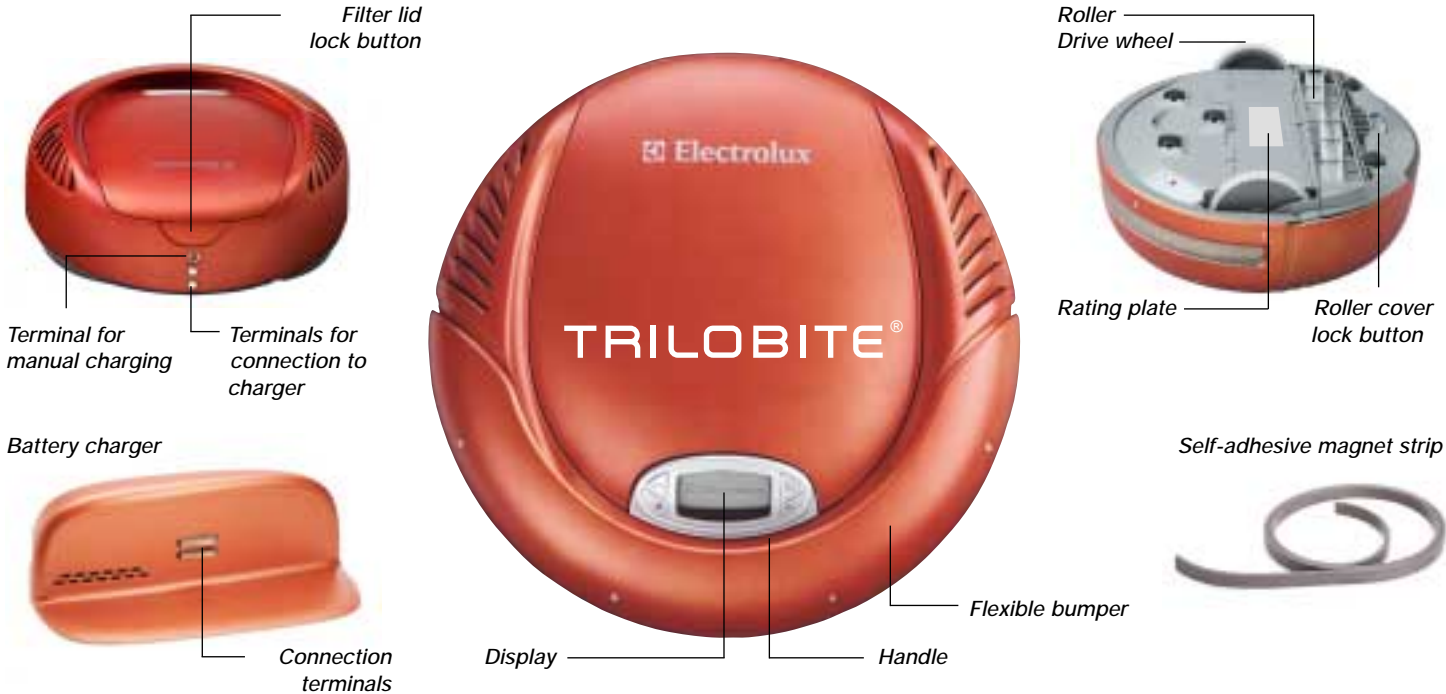

Trilobite

Trilobite navigates using ultrasound. During Wall Mapping, it receives information about the size of the room. Wall mapping serves as the basis for the estimated duration for independent vacuuming in the Normal vacuuming mode.

NOTE! Trilobite is not fully charged upon delivery. Before using it the first time, connect it to the battery charger. (Refer page 24.) A full battery charge requires approximately two hours.

Battery charger

Put the battery charger on the floor, connect it to the mains and place it with its rear side facing the wall. Allow a free space of 0.2 metres on the right side of the charger. When Trilobite has completed Normal vacuuming, it returns to the charger. The batteries are then charged and it is ready for more work.

Magnetic strips

The magnetic strips serve as “virtual walls” and are important for correct operation. Use them to e.g., block door and wall openings and staircases. (Refer to page 25.)

NOTE! Be sure to block staircases, landings, etc. with the magnetic strips. If you do not do this, Trilobite can pass over e.g., a staircase landing and cause injuries and damage to property.

A magnetic strip that has once been removed has poorer adhesive capability. We therefore strongly recommend that you attach the necessary strips once and for all. Never reuse a magnetic strip on a stair or in any other important application where safety is an important parameter. If you nonetheless choose to let the magnetic strip lie unfastened on the floor, make sure that the side with the adhesive (with the protective paper backing) faces downwards! Use a pair of scissors or a knife to trim the magnetic strip to the correct length. See page 9 in the user instructions to see how the magnetic strip should be fitted. Magnetic strips are available in a range of lengths and versions, see page 32.

Emptying the dust collector

Empty the dust collector when the dust collector icon lights in the display. Be sure to empty the dust collector if it is not completely full. The light indicator may be due to e.g., a blocked filter.

For Your Own Safety

Trilobite is a machine that moves by itself. It is tempting to prying children’s fingers and is at work when nobody is around... With this in mind, it is important to read the following before you put it to work.

 Danger  Warning  Precaution

General

Use

Only use Trilobite for normal household vacuuming.

Do not use Trilobite to vacuum

- *outdoors*
- *attics or basements*
- *bathrooms, washing rooms or other wet rooms*
- *ventilation rooms, inside false ceilings, etc.*
- *staircases*
- *tabletops, shelves, etc.*
- *warehouses, industrial buildings, etc.*

Children

Do not leave children alone with Trilobite. Children are curious and Trilobite is exciting. If a child by mistake starts the machine, he/she could become scared, run away with the risk of injuries.

Magnetic strips

Do not install magnetic strips close to magnetic objects, since the magnetic fields generated by them may affect the function of the magnetic strips. Consequently, move magnetic objects to another place in the room.

Carpet wear

In exceptional cases, Trilobite’s brush roller may cause certain carpet types to wear quickly.

Before vacuuming

Risk of falling

Trilobite cannot sense level differences. Because of this, it might easily travel down a stairway or fall off a terrace, balcony, attic, etc. It may even start climbing up inclines, e.g., slides in children’s rooms. Consequently, be sure to close all doors and “box” it in with magnetic strips. (Available as after sales item.)

Loose objects on tables, etc.

Trilobite automatically stops two centimetres in front of e.g., chairs, tables and pedestals. However, there is a chance Trilobite can catch suspended electric cords, tablecloths, belts, cords, etc. In the worst case, Trilobite will pull objects off tables and cabinets or down your walls.

Objects on the floor

Put away small objects on the floor, which might be vacuumed by Trilobite.

Combustibles

Never use Trilobite to:

- *Vacuum rooms with lit candles, lamps, etc.*
- *Vacuum rooms with open fire or embers in an open fireplace without supervision*
- *Vacuum rooms where curtains or other textiles can become stuck to e.g., electric radiators*
- *Vacuum combustible substances such as petrol, white spirit, thinner, etc.*
- *Vacuum glowing cigarette butts*

Because Trilobite can build up static electricity, never use it in rooms where the air contains:

- *Combustible gasses, such as petrol, white spirit, thinner, etc.*
- *Gasses from hairspray or deodorants*

Do not spray the Trilobite with fragrances when it is operating.

While cleaning

Risk of personal injury

When Trilobite is working, somebody could stumble over it. This may especially happen when Trilobite is returning to the charger – in this case it is quiet as a whisper. With this in mind, make sure everybody in your home knows that Trilobite is working.

Do NOT sit or stand on Trilobite!!!

Liquids

NOTE! Do not allow Trilobite to vacuum liquids, since this may severely damage the machine.

After vacuuming

Batteries

Only allow an Electrolux service centre to replace the batteries since the use of incorrect batteries may cause overheating. Do not under any circumstances heat the batteries!

Cleaning the filter unit

Carefully empty the filter unit. Dust collected in the unit can cause allergic reactions in sensitive persons. (Use only original Electrolux micro filters for a snug fit.)

Be especially careful if there is a chance Trilobite has vacuumed rat poison, detergent, disease carriers, etc.

Please also pay attention to the fact that Trilobite may have vacuumed e.g., insects or spiders.

Tip: Empty the filter unit in a plastic bag, while ensuring the bag fits tightly around the unit.

Storing

Make sure small children cannot start Trilobite by accident.

Preparations Before Use

Recharging

Push the Trilobite unit with its rear against the battery charger's contact plate. Press it in securely. Keep it pressed in until you hear an acknowledging signal (this may take a few seconds). This is particularly important if the batteries are entirely – or almost entirely – discharged.

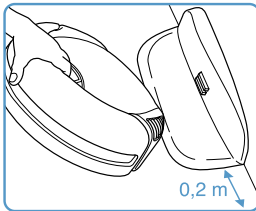

The battery charger is placed along a wall with a free margin of 0.2 m to the right of the charger.

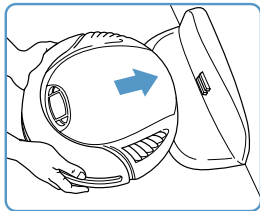

An audible signals sounds and the battery symbol in the display commences. Trilobite becomes fully charged in about two hours at which time "Ready" lights in the display.

Battery indicator

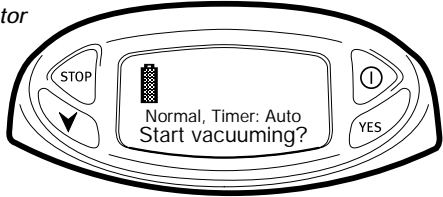

Charging status

The battery indicator on Trilobite's display shows the battery capacity during vacuuming and charging.

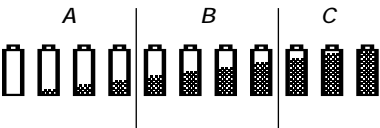

You may well develop a personal affection to Trilobite and appreciate its intelligence. To get the best from your Trilobite, we recommend you consider following

Charging (see also picture "Charging status")

Check the battery indicator before vacuuming starts. Refer to the lower, right picture.

- A. Charge your Trilobite before vacuuming
- B. You can commence vacuuming. But your Trilobite will need to find the charger soon.
- C. You don't need a charger in the room to start vacuuming

Avoid interrupting the charging process. If unavoidable, pull the machine away from the charger and press the On/Off button. Vacuuming can also be started while Trilobite is still being charged. If the power to the charger is interrupted for more than 30 seconds during charging, and you have not manually placed Trilobite in the charger, it will leave it, take a spin on the floor and then connect with the charger again.

Move the furniture

Trilobite picks its way around furniture, whether freestanding or placed flush against a wall. However, cleaning is both quicker and more effective if you move the furniture slightly before it is time to start cleaning. Of course, you do not need to move heavy furniture such as sofas. On the other hand, chairs can be conveniently placed on top of tables, a standard lamp can be moved out of the way onto an armchair, loose rugs can be shifted. But don't complicate matters more than you need to! Normally, all you need to do is to put Trilobite on the floor and let it get on with the job of cleaning.

Loose objects

Trilobite cannot distinguish between dust, coins, rings and expensive jewellery. Before starting Trilobite, be sure to put away small, loose objects you do not want to lose.

Also make sure there are no cords or other objects on the floor that may prevent Trilobite from moving freely in the room.

For your own safety

Before vacuuming, read "For your own safety" on page 22-23!

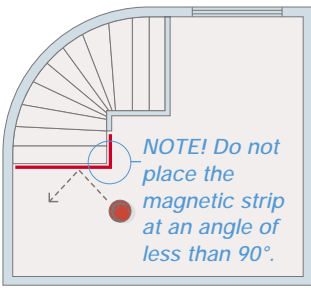

1. Room with a staircase

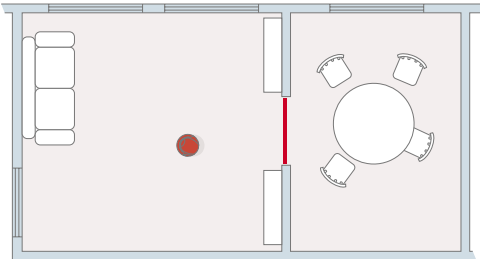

2. Room with wall openings

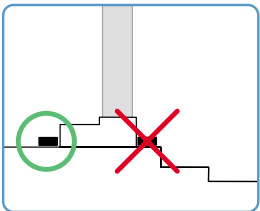

3. Rooms with doorsteps

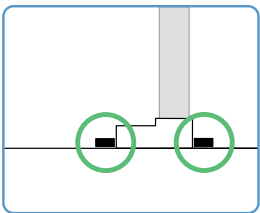

4. Rooms with doorsteps

Rooms with a staircase

Trilobite cannot see staircases or other level differences. To prevent it from falling down the stairs, block access to the staircase with a magnetic strip as shown in picture 1.

Rooms with wall openings

Trilobite is able to vacuum rooms with wall openings or walls placed at odd angles. However, this will take longer than usual. It is a good idea to vacuum one room at a time and separate the rooms using magnetic strips as shown in picture 2.

Rooms with doorsteps

Always fit magnetic strip on the floor in front of the doorstep in the room you will be vacuuming. See picture 3 and 4.

Magnetic strips and carpets

If the carpet has a pile depth of less than 15 mm, the magnetic strip can be placed under it with maintained functionality. If the strip is fitted on top of the carpet, be sure it is securely attached.

Affixing the magnetic strip
5. Clean the surface with the enclosed cleaning pad. Allow to dry.

6. Pull off the protective padding.

7. Affix the magnetic strip. Warning! Credit cards, etc. held in the immediate vicinity may become demagnetised.

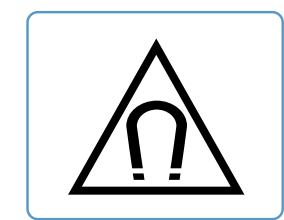
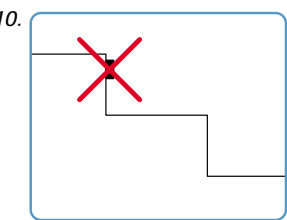
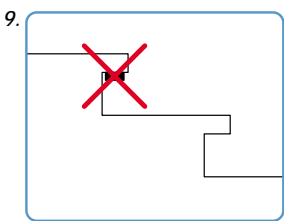
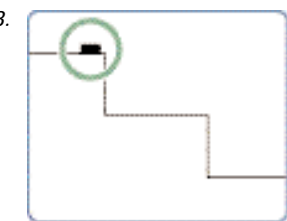
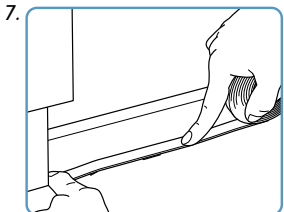
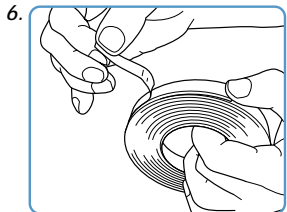
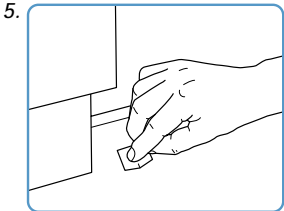

Always attach the magnetic strip on top of the step (Figure 8) and never along its side (as shown in Figure 9 and 10).

Buttons and Display

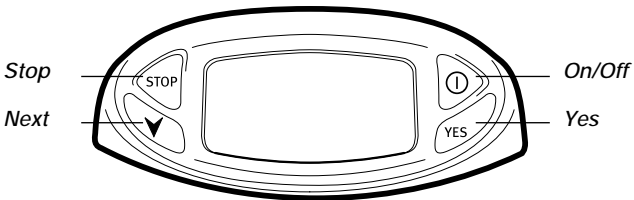

On/Off
Press the On/Off button for about one second to start and stop Trilobite.

Stop
The Stop button has two functions. Use it to cancel a command or to stop Trilobite during vacuuming.

Yes
Press the Yes button to confirm a setting shown on the display.

Next
Use the Next button to select items on the menu. Also use the Next button as a “No” button when you do not want to select a setting presented in the display.

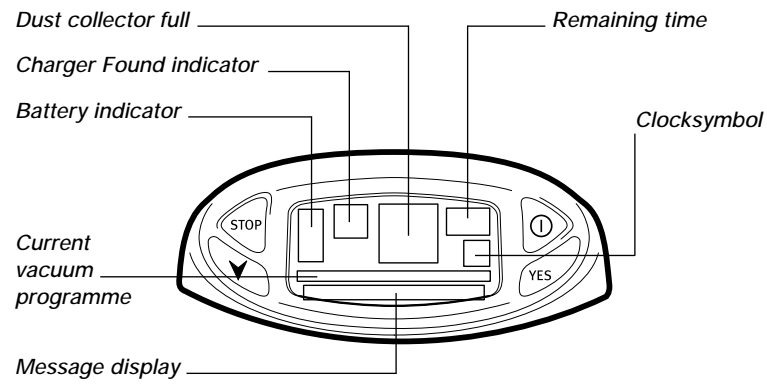

Symbols
Information is shown in the display using status messages and also by symbols.
(The battery capacity symbol is shown on page 24.)

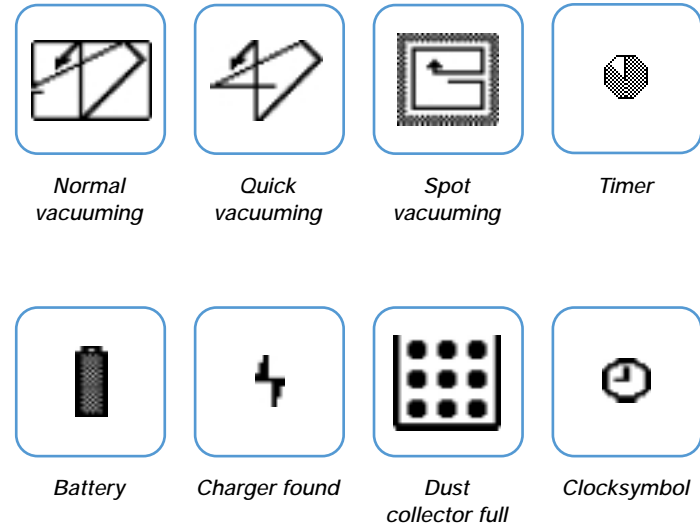

Vacuuming Programmes

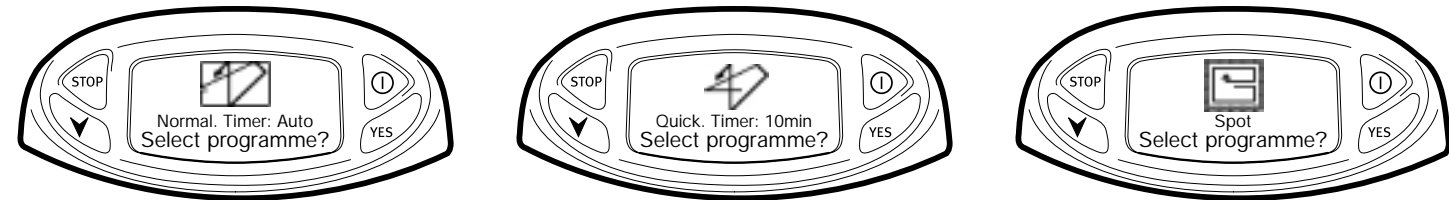

Normal vacuuming
When you start Trilobite it is ready to start vacuuming using the Normal programme and automatic time calculation.

1. (When Trilobite is switched off and on the floor or placed in the charger), press ① to start.
2. Press YES to start vacuuming.
3. If you want to select another programme, press ▼.
4. If you would like to change the vacuuming programme, press YES (continue to “Quick vacuuming” or “Spot vacuuming”).
5. If instead you would like to change the time setting (this may be necessary when vacuuming floor surfaces of 40 m² or more), press ▼ again and confirm by pressing YES.
6. Use ▼ to display “On” and then confirm by pressing YES.
7. Set the desired time by pressing ▼ and then confirm with YES.
8. Press YES to commence vacuuming.

NOTE! Never start Normal vacuuming at distances under 0.5 m from a magnetic strip. Vacuuming can always be interrupted by pressing STOP. After this, pressing YES recommences vacuuming, while pressing ▼ will call up the menu.

Quick vacuuming
The Quick programme is identical with Normal vacuuming except that wall mapping is not included. Vacuuming takes shorter time with the duration preset to 10 minutes, however, the vacuum result may be slightly inferior.

1. After you have switched on Trilobite, press ▼ to change the programme and confirm by pressing YES.
2. Use ▼ until “Quick” is displayed and confirm by pressing YES.
3. If you don’t want to change the time setting, put Trilobite on the floor and start vacuuming by pressing YES.
4. If instead you would like to change the time setting, press ▼ until “On” is displayed and confirm by pressing YES.
5. Set the desired time by pressing ▼ and then confirm with YES.
6. Put Trilobite on the floor and start vacuuming by pressing YES.

NOTE! Vacuuming can always be interrupted by pressing STOP. After this, pressing YES recommences vacuuming, while pressing ▼ will call up the menu.

Spot vacuuming
Use Spot vacuuming to quickly vacuum a limited area, e.g. if you have spilled something. The area to be vacuumed is approx. 1 m² with Trilobite placed in the centre of the area. The area is vacuumed twice.

1. Switch on Trilobite, press ▼ to change the programme and confirm by pressing YES.
2. Use ▼ until “Spot” is displayed and confirm by pressing YES.
3. Put Trilobite in the centre of the area to be vacuumed and start vacuuming by pressing YES.

⚠ Do not under any circumstances vacuum liquids or lit or glowing objects, e.g. cigarette butts.

NOTE! Vacuuming can always be interrupted by pressing STOP. After this, pressing YES recommences vacuuming, while pressing ▼ will call up the menu.

Timer

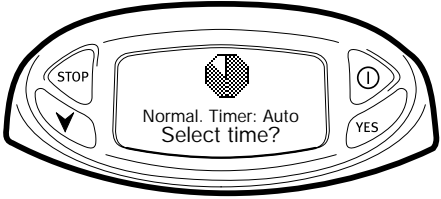

Timer

It is possible to set the time duration for Normal or Quick vacuuming.

1. Select the desired vacuum programme and press **YES** to confirm.
2. Use **▼** until "On" is displayed and confirm by pressing **YES**.
3. Set the desired time duration using **▼** and confirm by pressing **YES**. (For normal vacuuming, this is the time vacuuming lasts, i.e. not including wall mapping.)
4. Put Trilobite on the floor and start vacuuming by pressing **YES**.

Changing the Message Display Language

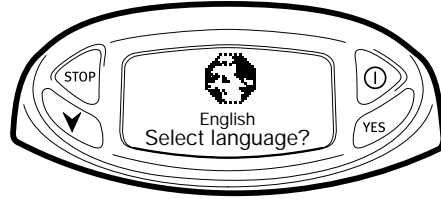

Language

Trilobite can show display messages in English or Swedish.

1. To change the display language, switch on Trilobite and press **▼**.
2. The display will ask whether you want to change the programme. Ignore this and press **▼**.
3. The display will ask whether you want to change the time setting. Ignore this and press **▼**.
4. The display will ask whether you want to change the language. Press **YES**.
5. Press **▼** to select the desired language and confirm by pressing **YES**.

Trilobite will now show display messages in the selected language.

Status Messages

When you select a function, a status message is shown on the display for about seven seconds. After this, the name of the function is shown again. It is of course possible to change or confirm a displayed function even while the status message is shown.

Error Messages

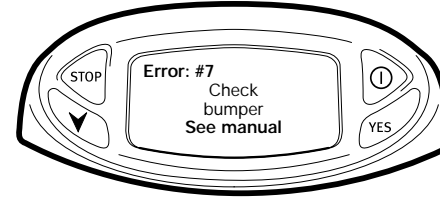

Error Messages

The only faults that you can rectify yourself are the ones listed below. In the event of other error messages, recharge and restart your Trilobite. If it still does not start, contact our Customer Service on 020-53 53 50.

- The errors you can correct yourself are presented below:
5. Check roller.
Is something stuck? Is it incorrectly attached?
 6. Check casters.
Is something stuck?
 7. Check bumper.
Verify its spring action. Is something stuck preventing it from moving?
 12. Trilobite is stuck.
Move it and switch it on again. Also see Normal Vacuuming on page 4.
 15. Check dust cassette.
In most cases, the filter unit has probably not been set or it is incorrectly set.
 16. Check charger.
Is the charger connected to the mains?
Are the terminals on the charger and Trilobite properly connected to each other?
 21. Moisture on the circuit board.
Let the machine dry out for 12 hours.
Then try restarting it.

Questions and Answers

Should I pay attention to anything special when I vacuum a room for the first time?

It is a good idea to be present when the room is vacuumed the first time, for example to see if it takes unnecessary time for Trilobite to navigate around furniture.

Can I use Trilobite in a room with an activated alarm?

Yes, if it has a "pets monitoring" facility.

Can I hide the magnetic strips under e.g. a carpet?

Yes, as long as it not thicker than 15 mm.

What is the purpose of the audible signals?

They confirm that a command or measure has been correctly received or to advice a problem.

Trilobite operates at different speeds. Is something wrong?

Not at all. The speed varies depending e.g. on the layout and furniture in the room.

Is it all right to always leave Trilobite connected to the charger when it is not is use?

Yes, but make sure children cannot start it by mistake.

Is it necessary to switch off Trilobite before charging it?

No.

How can I know whether I have placed Trilobite correctly during manual battery charging?

A battery symbol lights in the display and you hear an audible signal.

Why doesn't it charge?

1. Check that Trilobite is correctly connected to the charger (see the question above).
2. Check that the charger has been connected to the mains.

Is it dangerous to touch the charging terminals?

No. They have no power in the output mode and carry max. 28 V in the input mode.

Why does Trilobite sometime pause for approximately 10 seconds during vacuuming?

1. Trilobite uses two battery packs. It will briefly pause when switching from one battery pack to the other.

Why does Trilobite stop completely during vacuuming?

1. Check that it has been sufficiently charged. See page 24.
2. Did it find the charger during wall mapping?
3. The time duration for vacuuming may need to be increased. See page 28.

Why does Trilobite crackle while vacuuming?

This sound is produced by the navigation system.

Why do I need to replace the filter so often?

The filter is actually one of the most important components in the machine. It collects all dust, even very small dust particles (this is why you should also use original Electrolux filters). Just like a dust bag becomes full, so does the filter. There is no dust bag in the Trilobite, but the filter is always a necessity.

If Trilobite starts to smell bad, what could this be due to?

Probably the dust filter was not replaced.

What should I do when an error message is displayed?

The error messages you can correct yourself are shown on page 28. In all other cases, contact Customer Service by calling 020-53 53 50.

What is the Cable Protection System?

This is simply a system that prevents Trilobite from getting stuck in electric cords on the floor.

What is the Trilobite Stairsafe system?

This is a safety measure that prevents Trilobite from falling down staircases when they have been cordoned off with the magnetic strips.

Do I need to vacuum myself also?

Sometimes this may necessary no matter which vacuum programme you use, especially in corners or along the walls in the room.

Emptying and Cleaning the Dust Collector

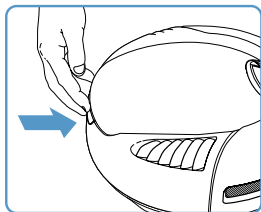

1. Press the button on the rear side of Trilobite, and ...

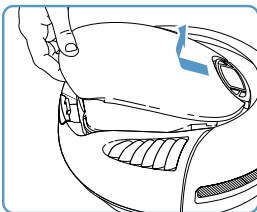

2. ... lift off the lid.

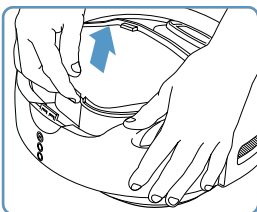

3. Take out the dust collector.

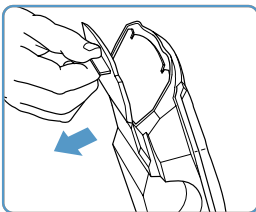

4. Remove the grille with the opening facing up.

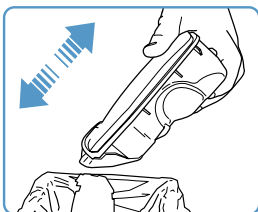

5. Empty the collector (preferably in a plastic bag fit snugly around the unit).
NOTE! Do not knock the collector against hard surfaces to empty it.

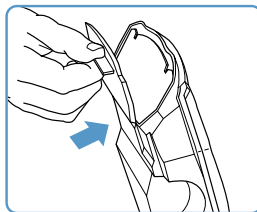

6. Insert a new filter and replace the grille.

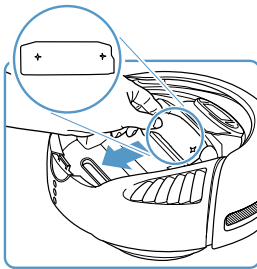

7. Replace the motor filter for each tenth time the dust collector filter is replaced. Attach the filter with the cut-off corners facing to the right.

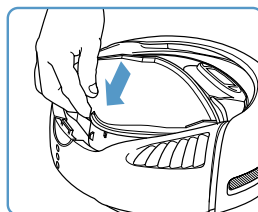

8. Replace the dust collector.

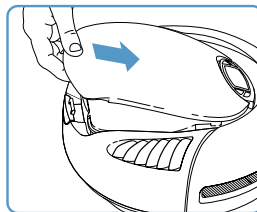

9. Replace the lid, and ...

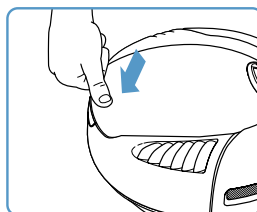

10. ... push down on the lid. If the lid cannot be properly closed, the dust collector is most likely set incorrectly.

Cleaning the Roller

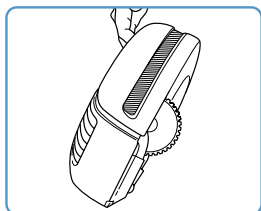

1. Check the roller each time the dust collector is emptied. Begin by lifting Trilobite by the handle.

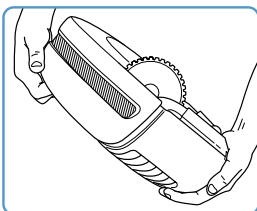

2. Turn Trilobite upside down and put it on a soft surface with the display facing you.

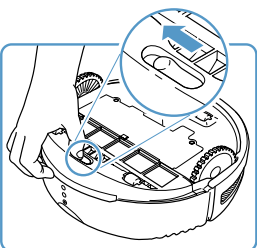

3. Push the locking knob to the right.

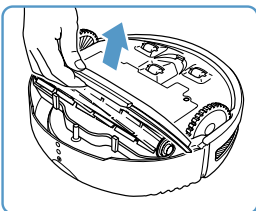

4. Raise the cover.

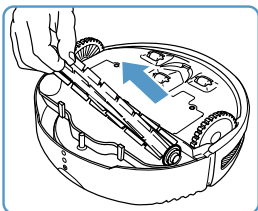

5. Lift the roller by the end without a drive belt. Remove it by holding it at an angle and pulling upwards/outwards.

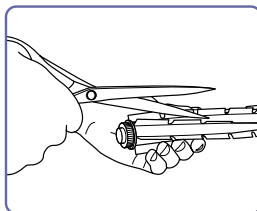

6. Clean the roller. Use a pair of scissors to cut away strings, threads, etc. NOTE! Do not wash the roller in water or other liquids.

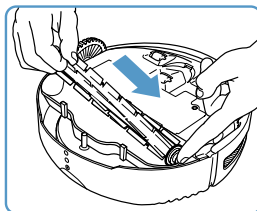

7. Slide in the roller, take care to secure the belt and rotate it so that the teeth engage securely.

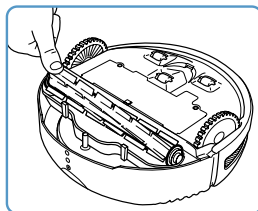

8. Press the roller downwards/inwards.

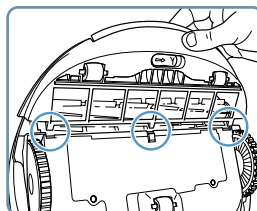

9. Replace the lid. When the three pegs in the picture are placed correctly, the lid is in the correct position.

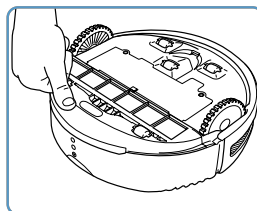

10. Finally push down the lid in place.

Accessories

Battery charger



Filter



Magnetic strips



Battery charger

To make vacuuming easier, you can purchase additional chargers. Why not one for each room? Or one for your weekend cottage? Order number: ZAC

Magnetic strips

You can also purchase additional magnetic strips. They come in many different designs and with different surface coatings. For more information, contact your dealer, our Customer Service department, or visit our web site. Order number: ZE 110

Filter

Filters come in 10+1 packages, i.e., 10 filters for the dust collector and one motor protection filter (the latter should be replaced for each tenth time the dust collector is emptied). The filters are available from your dealer. You can also use our filter subscription service (contact Customer Service) – or order them from our web site. Order number: EF 110

Miscellaneous

The selection of accessories is continuously updated. Please contact your dealer, Electrolux Customer service or visit our web site for more information about new accessories.

After-Sales Service

(Sweden only)

Customer Service

Accessories, service, problems ... No matter what type of question you may have about your Trilobite, you are always welcome to contact our Customer Service on 020-53 53 50, on weekdays between 8-11.30 and 13-16, or to get in touch via E-post at: info.trilobite@electrolux.se

After you have purchased your Trilobite, please fill in the information in the spaces below. This information can be found on the rating plate underneath Trilobite. Please have this information ready when you contact Customer Service.

Serial number:

Purchase date:

Warranties

Trilobite is covered by the conditions in the Swedish Consumer Protection Act '91 and other EHL regulations. Please contact your dealer or Customer Service for detailed information.

NOTE! Be sure to save the purchase receipt and the EHL insurance certificate.

Reservations

Electrolux will not accept any responsibility for damage caused by incorrect use or unauthorised modifications of the product. Product designs and specifications are subject to change without notice.

The products are protected by patents or registered designs.

For more information on purchasing filters and other accessories, please visit our web site at www.electrolux.se or call 08-738 62 62 working days 07.30–17.00.

Technical Specifications

Trilobite	
Model name	ZA1
Diameter	350 mm
Height	130 mm
Weight	5 kg
Noise level	approx 75 dBA
Power	approx 90 W
Speed	max 0,4 m/sec.
Navigation	180° ultrasound
Quick stop	lift the machine
Dust collector	1,2 l
Vacuum duration	approx 60 min/charge
Batteries	Environmentally friendly Nickel-Metal hybrid
Charging duration	approx 2 hours
Charger	
Charger name	ZAC
Height	130 mm
Width	160 mm
Length	380 mm
Weight	0,8 kg
Input voltage	AC 230-240 V, 50/60 Hz
Output voltage	max DC 28 V
Power	60 W
Cord length	180 cm

Declaration of conformity

Concerning Machinery Directive – 98/37/EC
Low Voltage Directive – 73/23/ECC
EMC-Directive – 89/336/ECC
Manufacturer: Electrolux Floor Care & Light Appliances
S-593 84 Västervik, SWEDEN
Declares that the automatic household vacuum cleaner Trilobite with charger – ZA1 (machine) and ZAC (charger) conforms with the productive requirements of the Machinery Directive 98/37/EC, the Low Voltage Directive 73/23/EEC and the EMC Directive 89/336/EEC.
It is further declared that the automatic household vacuum cleaner Trilobite with charger – ZA1 (machine) and ZAC (charger) conforms with the productive requirements of the following harmonised European standards:
Machinery Directive: EN 292-1 (1992), EN 292-1 (1992) and A1 (1995), EN 1050 (1996).
Low Voltage Directive: EN 60335-1 (1994) and A11 (1995), A12 (1996), A1 (1996), A13 (1998), A15 (2000), EN 60335-2-2 (1995) and A1 (1998), A2 (2000) EN 61558-2-17 (1997).
EMC Directive: EN 55014-1 (1993) and A1 (1997), A2 (1999), EN 55014-2 (1997), EN 61000-3-2 (1995), EN 61000-3-3 (1994), EN 55022 (1994) and A1 (1995) Class B.
Low Voltage tests and EMC-tests have been conducted by authorised organisations.
Low Voltage tests: UL International DEMKO A/S, Lyskaer 8, DK-2730 Herlev, DENMARK.
EMC-tests: SEMKO AB, Box 1103, S-164 22 Kista, SWEDEN.

Västervik 2001-09-28

Ola Carlsson, Platschef