

## SYSTEM\_PRO

Combi-Vac with  
Detachable Hand Vac

Household Type

Owner's Guide  
Model S107

### IMPORTANT

Do not return this product to the store. Call 1-800-800-8975\* Monday - Friday, 8 am to 7:30 pm CST and 10 am to 6:30 pm Saturday or visit our web site, [www.sanitairevac.com](http://www.sanitairevac.com) for any of the following:

- assembly problems
- replacement of broken or missing items
- to order replacement parts and accessories
- to locate the nearest Sanitaire Warranty Station

\*En Mexico llame al (55) 5343-4384

[www.sanitairevac.com](http://www.sanitairevac.com)

### PLEASE RETAIN

We suggest you record the model, type and serial numbers below. They are located on the silver rating plate on your cleaner. For prompt and complete service information, always refer to these numbers when inquiring about service.

Model & Type \_\_\_\_\_

Serial No. \_\_\_\_\_

It is also important to keep your receipt as proof of date of purchase.

## Index

Important Safeguards .....	2
Service Information .....	2
Assembly .....	3
Use .....	4
Accessories .....	5
Dust Cup .....	6
Filter .....	6
Brush Roll .....	6
Problem Solving .....	7
Warranty .....	8
Customer Order Form .....	9

## GENERAL INFORMATION

**To reduce the risk of electric shock**, this appliance has a polarized plug (one blade is wider than the other). The plug will fit in a polarized outlet only one way. If the plug does not fit fully in the outlet, reverse the plug. If it still does not fit, contact a qualified electrician to install the proper outlet. Do not change the plug in any way.

The bag may have come dislodged in shipping. Check the bag to insure proper seating before attempting to use the cleaner. Do not operate the cleaner without the filter. Damage may result to the motor.

The cleaner is designed to pick up dirt and dust particles. Avoid picking up hard or sharp objects with the cleaner to avoid bag breakage, hose clogging, or possible motor damage.

## Service Information

The instructions in this booklet serve as a guide to routine maintenance. If additional service is required, telephone toll free:

**USA: 1-800-800-8975**

**Mexico: (55) 5343-4384**

**Canada: 1-800-800-8975**

If you prefer, you can write to Electrolux Home Care Products North America, Consumer Service, P.O. Box 3900 Peoria, Illinois 61612, USA. In Canada write to Electrolux Home Care Products North America, 866 Langs Drive, Cambridge, Ontario N3H 2N7. Refer to The Sanitaire Limited Warranty for complete service information.



**DO NOT OIL the motors or the brush roll at any time. The bearings are permanently lubricated and sealed.**

# IMPORTANT SAFEGUARDS

When using an electrical appliance, basic precautions should always be followed, including the following:

**READ ALL INSTRUCTIONS  
BEFORE USING THIS VACUUM CLEANER.**

## WARNING

To reduce the risk of fire, electric shock, or injury:

- Do not use outdoors or on wet surfaces.
- **Do not leave vacuum cleaner when plugged in.** Turn off the switch and unplug the electrical cord when not in use and before servicing.
- Do not allow to be used as a toy. Close attention is necessary when used by or near children.
- Use only as described in this manual. Use only manufacturer's recommended attachments.
- Do not use with damaged cord or plug. If vacuum cleaner is not working as it should, has been dropped, damaged, left outdoors, or dropped into water, return it to a service center before using.
- Do not pull or carry by cord, use cord as a handle, close a door on cord, or pull cord around sharp edges or corners. Do not run vacuum cleaner over cord. Keep cord away from heated surfaces.
- Do not use extension cords or outlets with inadequate current carrying capacity.
- Turn off all controls before unplugging.
- Always turn off this appliance before connecting or disconnecting the hand vacuum.
- Do not unplug by pulling on cord. To unplug, grasp the plug, not the cord.
- Do not handle plug or vacuum cleaner with wet hands.
- Do not put any object into openings. Do not use with any opening blocked; keep free of dust, lint, hair, and anything that may reduce airflow.
- This vacuum cleaner creates suction and contains a revolving brush roll. Keep hair, loose clothing, fingers, and all parts of body away from openings and moving parts.
- Do not pick up anything that is burning or smoking, such as cigarettes, matches, or hot ashes.
- Do not use without dust bag in place.
- Belt pulleys can become hot during normal use. To prevent burns, avoid touching the belt pulley when servicing the drive belt.
- Use extra care when cleaning on stairs.
- Do not use to pick up flammable or combustible liquids such as gasoline, or use in areas where they may be present.
- Store your cleaner in a cool, dry area.
- Keep your work area well lighted.
- Unplug electrical appliances before vacuuming them.

# SAVE THESE INSTRUCTIONS

# How To Assemble

**CAUTION:** Assemble the cleaner completely before plugging into an electrical outlet.

**CAUTION:** Moving parts, stay clear of brush roll when plugging in. Make sure brush roll is clear of moving parts when plugging in.

**NOTE:** Features may vary by model yet all parts assemble the same.

## Step A Unpack Body of Vacuum and Handle

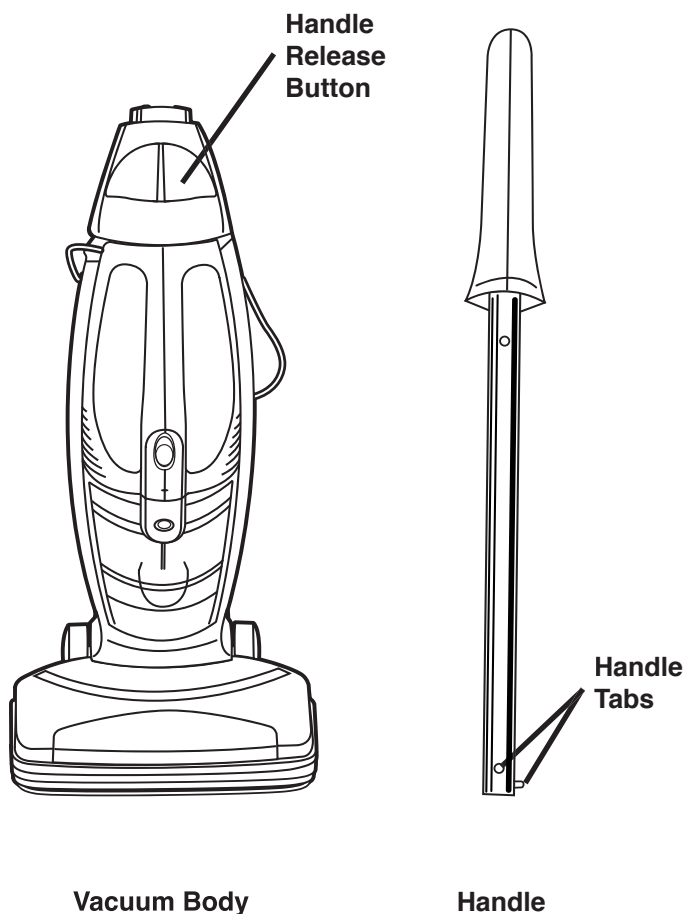

1. Remove vacuum body and handle from carton. Locate the handle release button on body and the handle tabs on handle.

## Step B Attach Handle

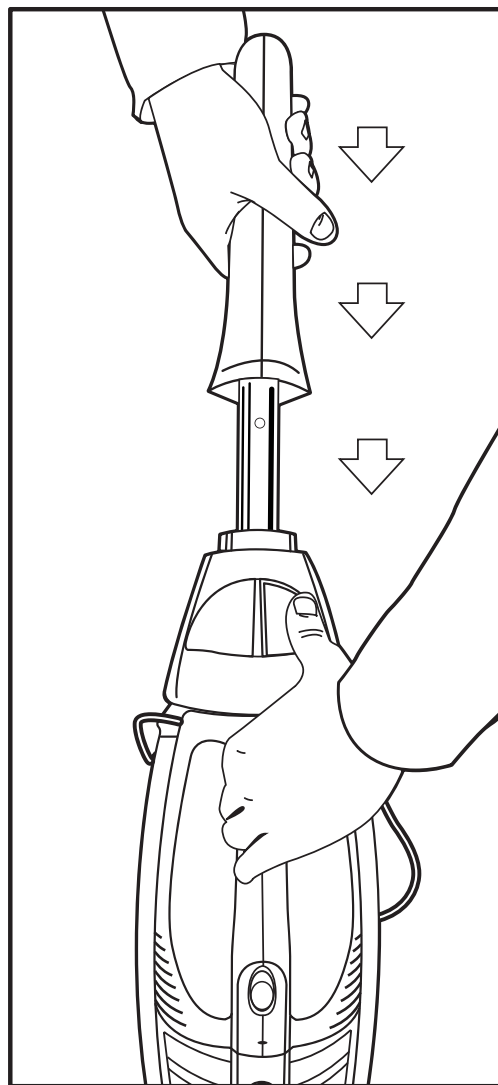

2. Position handle above vacuum body. Line up the handle tabs to the notches in the opening at the top of the vacuum body.
3. Press down on the handle release button as shown above. Slide the handle down into the unit, until it clicks into place.

# How To Use

**CAUTION:** Do not plug in cleaner until you understand all controls and features.

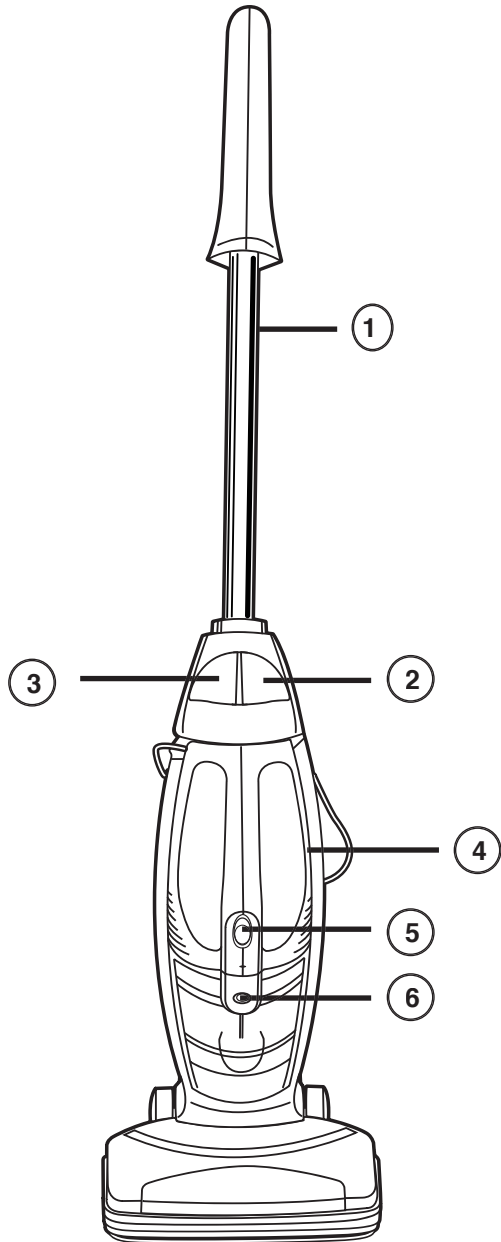

1. **Telescoping Handle.** The handle has two positions, all the way up or all the way down.
2. **Handle Release Button.** Push in on this button when you want to raise or lower the handle.
3. **Hand Vac Release Button.** Push in on this button to release hand vac from body.
4. **Crevice Tool.** The crevice tool is stored in the body of the vacuum behind the dust cup.
5. **Three Position On/Off Switch.** O = Off, I = Suction and IIII = suction with brush roll.
6. **Dust Cup Release Button.** Push in on this button to release dust cup from hand vac.

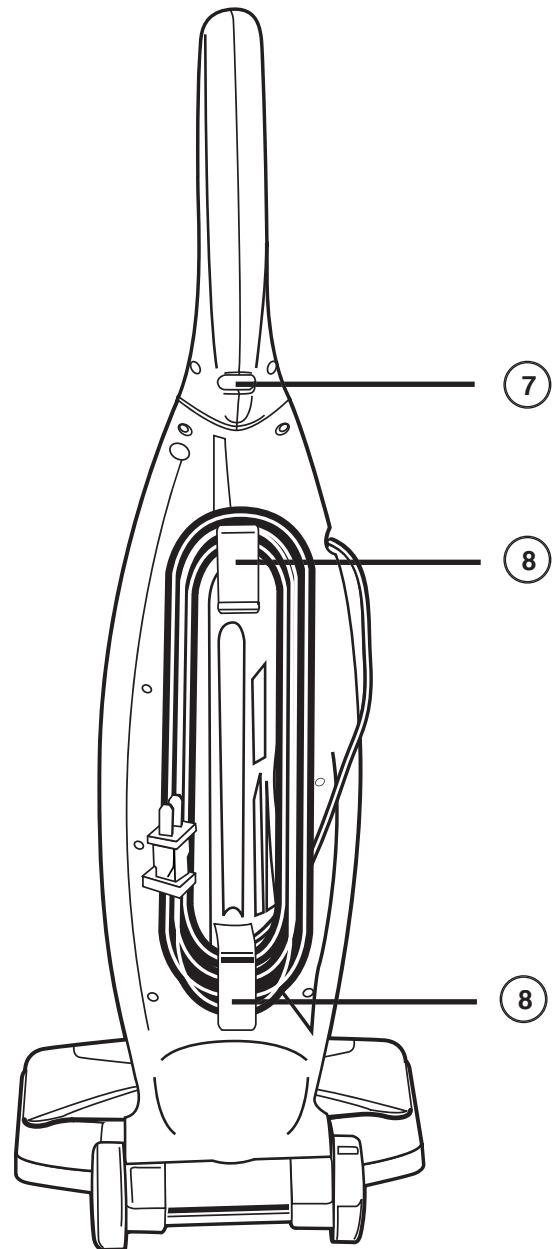

7. **Cord Retainer.** To use, push electrical cord into cord retainer.
8. **Electrical Cord Hooks (2).** Wrap electrical cord around them to store electrical cord on unit. Top hook rotates down for quick release of the electrical cord. Rotate back up to store electrical cord.

# How To Use Accessories

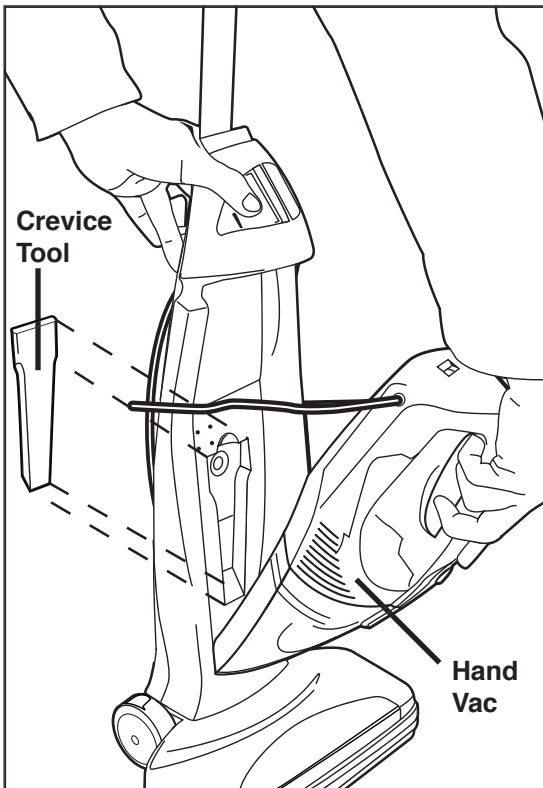

1. To remove the hand vac from the base, push in on the hand vac release button, and tilt hand vac out of base as shown to the left.

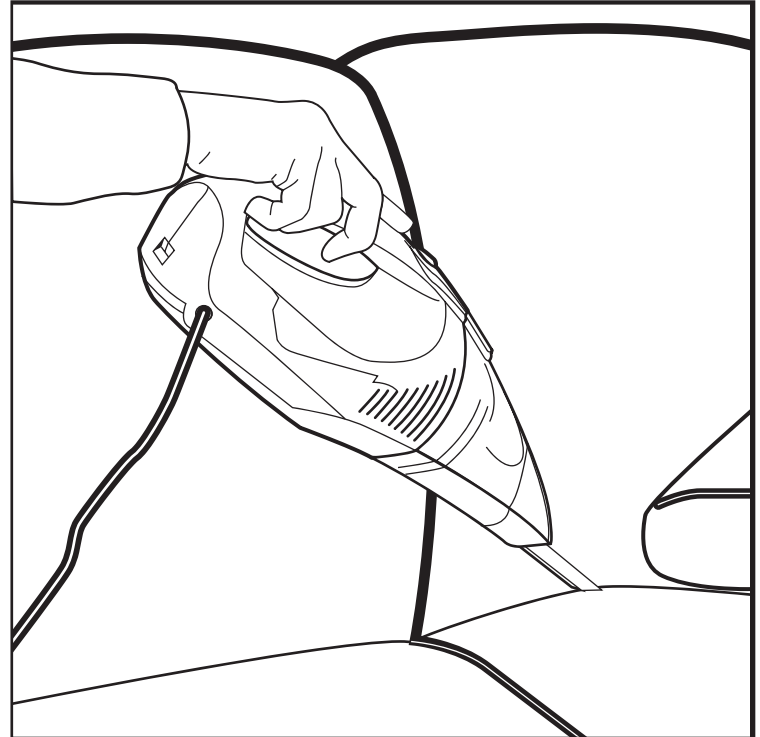

2. The crevice tool is stored in the base behind the hand vac. Pull crevice tool away from the base and put the wide end into the end of the hand vac nozzle. (See above) The crevice tool is used to clean corners, baseboards, between cushions.

3. To use as a stair vac, collapse handle. Push in on the handle release button and push handle down into unit. See below.

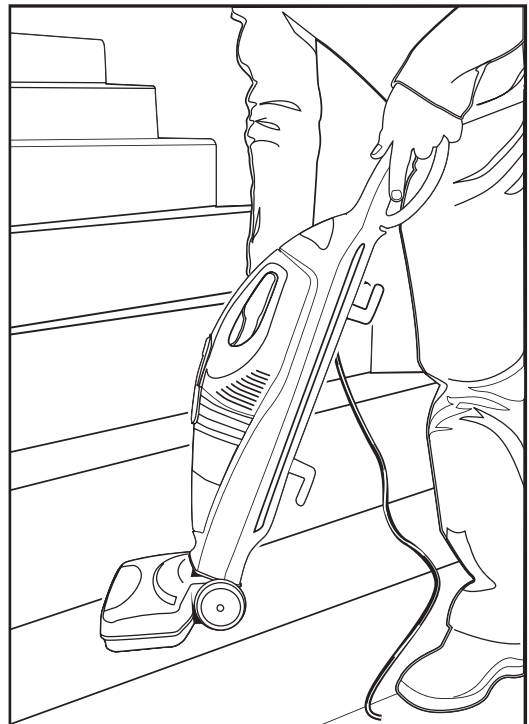
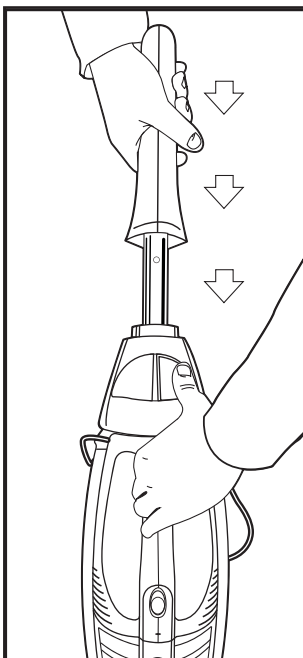

**CAUTION:** Use extra care when cleaning on stairs.

# How To Maintain

The instructions in this booklet serve as a guide to routine maintenance. To keep the cleaner operating at top efficiency empty the dust cup and clean the filter after each use.

## Empty Dust Cup

**CAUTION:** Turn off the switch and unplug the electrical cord before servicing.

1. Remove hand vac from the base unit.
2. Push in on dust cup latch and pull dust cup from handle section.
3. Remove dust cup filter from dust cup. Shake and brush the dust and dirt from filter.

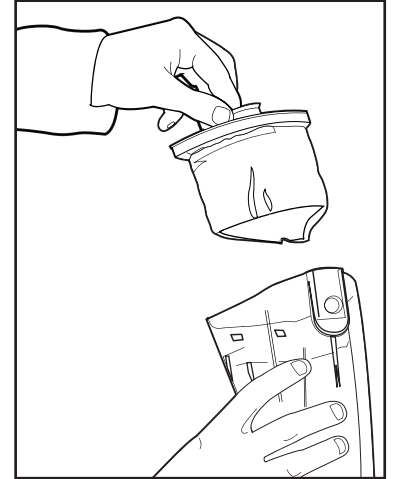
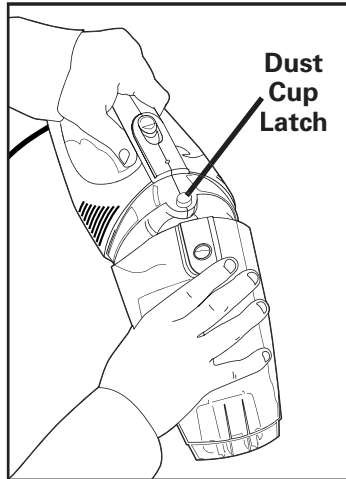
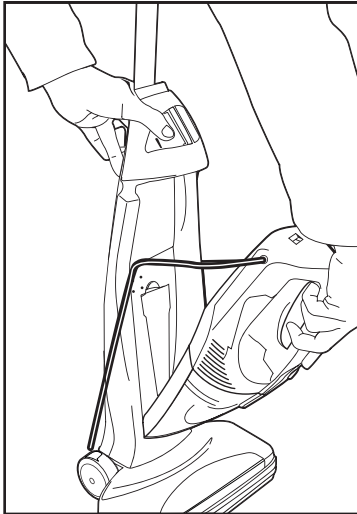

4. Shake contents of dust cup into a waste container.

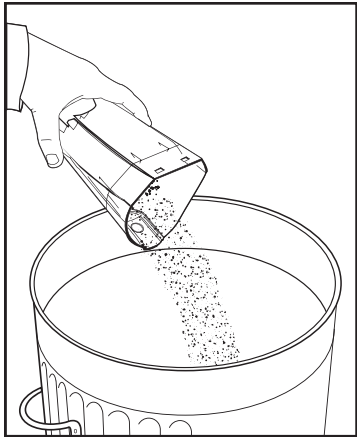

5. Replace **dry** dust cup filter in dust cup and reassemble following above directions in reverse.

**NOTE:** Replace a dirty or torn filter.

6. Dust cup may be cleaned with warm water and mild detergent. Wipe dry, do not put dust cup in dishwasher.

## Cleaning and Replacing Dust Cup Filter, PN 62406

Pull filter off of filter frame.

Shake and brush the dust and dirt from filter. If desired, launder filter by hand in warm water using a mild detergent.

**NOTE:** Air dry thoroughly before returning to use.

To put filter on filter frame, pull and stretch the elastic edge of filter up and over the rim on the filter frame.

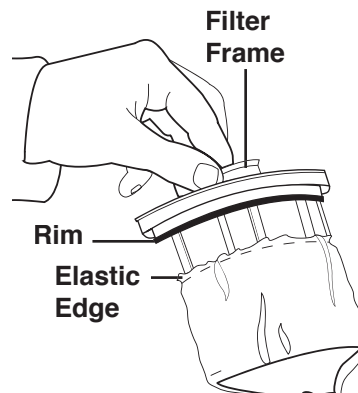

**Correct Installation**

**NOTE:** If filter is not properly installed, dirt and dust will go past the filter and this can damage the cleaner motor.

## Clean Brush Roll

The brush roll turns to sweep and comb the carpet nap. Keep the brush roll free from hair and threads so it will continue cleaning.

# PROBLEM SOLVING

**NOTE: Turn off the switch and unplug the electrical cord before servicing.**

PROBLEM	CAUSE	SOLUTION
Motor will not start.	<input checked="" type="checkbox"/> Electric Plug  <input checked="" type="checkbox"/> Check Power Switch	<input type="checkbox"/> Push plug securely into outlet. <input type="checkbox"/> Try another outlet. <input type="checkbox"/> Check circuit breaker. <input type="checkbox"/> Make sure power switch is on.
Does not clean the carpet or floor.	<input checked="" type="checkbox"/> Dust Cup and Filter  <input checked="" type="checkbox"/> Brush Roll  <input checked="" type="checkbox"/> Intake Nozzle	<input type="checkbox"/> Empty the dust cup and clean or replace the filter. <b>Hint:</b> If picking up fine dust, the dust cup may <u>not</u> look full but a fine substance tends to reduce suction when it blocks the airflow through the filter. <input type="checkbox"/> Be sure dust cup is properly installed in hand vac. <input type="checkbox"/> Clean hair and thread from bristles and end cap area. Replace brush roll if bristles are worn. <input type="checkbox"/> Remove hand vacuum from base and look for blockage in the air path from the floor nozzle to the hand vacuum. Lay the stick vacuum flat and use a screwdriver to pull the blockage up and out of the air path. Reattach the hand vacuum; turn the unit on to clear any remaining debris. Remove hand vacuum and recheck for additional clogs. Repeat above steps if needed.
No suction.	<input checked="" type="checkbox"/> Filter  <input checked="" type="checkbox"/> Intake Nozzle	<input type="checkbox"/> Clean or replace the filter. <b>Hint:</b> If picking up fine dust, the dust cup may <u>not</u> look full, but a fine substance tends to reduce suction when it blocks the airflow through the filter. <input type="checkbox"/> Remove hand vacuum from base and look for blockage in the air path from the floor nozzle to the hand vacuum. Lay the stick vacuum flat and use a screwdriver to pull the blockage up and out of the air path. Reattach the hand vacuum; turn the unit on to clear any remaining debris. Remove hand vacuum and recheck for additional clogs. Repeat above steps if needed.
Noise from brush roll area.	<input checked="" type="checkbox"/> Brush Roll	<input type="checkbox"/> Remove and clean debris from brush roll area. <input type="checkbox"/> Clean hair and threads from brush roll.
Brush roll not turning.	<input checked="" type="checkbox"/> Brush Roll  <input checked="" type="checkbox"/> Power Switch  <input checked="" type="checkbox"/> Hand Vacuum Secured	<input type="checkbox"/> Remove and clean debris from brush roll area. <input type="checkbox"/> Clean hair and threads from brush roll. <input type="checkbox"/> Switch has three positions; off (O), suction only (I) and suction with brush roll (III). <input type="checkbox"/> Remove hand vacuum from base. Reinstall into base by pushing firmly until hand vac locks into place.
How to maintain brush roll.	<input checked="" type="checkbox"/> Brush Roll Area      <input checked="" type="checkbox"/> Brush Roll Belt	<input type="checkbox"/> Remove and clean debris from brush roll area. <input type="checkbox"/> Clean hair and threads from brush roll. <input type="checkbox"/> Do not attempt to lubricate the bearings in the brush roll. They are permanently lubricated at the factory. <input type="checkbox"/> The brush roll belt is a clogged design that should not require replacement.



# THE SANITAIRE LIMITED WARRANTY

## What This Warranty Covers

Your Sanitaire cleaner is warranted to be free from all defects in material and workmanship in normal household use for a period of two years. The warranty is granted only to the original purchaser and members of his or her immediate household. The warranty is subject to the following provisions.

## What This Warranty Does Not Cover

- Parts of the cleaner that require replacement under normal use, such as disposable dust bags, filters, drive belts, light bulbs, and brush roll bristles.
- Damages or malfunctions caused by negligence, abuse, or use not in accordance with the Owner's Guide.
- Defects or damages caused by unauthorized service or the use of other than Genuine Eureka/Sanitaire parts.

## What Electrolux Home Care Products North America Will Do

Electrolux Home Care Products North America will, at its option, repair or replace a defective cleaner or cleaner part that is covered by this warranty. As a matter of warranty policy, Electrolux Home Care Products North America will not refund the consumer's purchase price.

## Extended Warranty for Upright Cleaner (Only)

The base of the Sanitaire Upright cleaner is warranted for five years from the original date of purchase.

## Extended Warranty for SYSTEM\_PRO Canisters

The motor for SYSTEM\_PRO canister cleaners is warranted for five years from the original date of purchase.

## Warranty Registration

Please fill out and return the warranty registration card accompanying your cleaner.

## Obtaining Warranty Service

To obtain warranty service you must return the defective cleaner or cleaner part along with proof of purchase to any Sanitaire Authorized Warranty Station. You will find the nearest location in the Yellow Pages, under "Vacuum Cleaners—Service and Repair." Be certain that the Warranty Station is "Sanitaire Authorized." For the location of the nearest Sanitaire Authorized Warranty Station or for service information, telephone toll free:

**USA: 1-800-800-8975**  
**Mexico: (55) 5343-4384**  
**Canada: 1-800-800-8975**

**[www.sanitairevac.com](http://www.sanitairevac.com)**

If you prefer, you can write to Electrolux Home Care Products North America, Service Division, P.O. Box 3900, Peoria, Illinois 61612, USA. In Canada write to Electrolux Home Care Products North America, 866 Lings Drive, Cambridge, Ontario N3H 2N7.

If it is necessary to ship the cleaner outside your community to obtain warranty repair, you must pay the shipping charges to the Sanitaire Authorized Warranty Station. Return shipping charges will be paid by the Warranty Station. When returning parts for repair, please include the model, type, and serial numbers from the data plate on the cleaner.

## Further Limitations and Exclusions

Any warranty that may be implied in connection with your purchase or use of the cleaner, including any warranty of Merchantability or any warranty for Fitness For A Particular Purpose is limited to the duration of this warranty. Some states do not allow limitations on how long an implied warranty lasts, so the above limitations may not apply to you.

Your relief for the breach of this warranty is limited to the relief expressly provided above. In no event shall Electrolux be liable for any consequential or incidental damages you may incur in connection with your purchase or use of the cleaner. Some states do not allow the exclusion or limitation of incidental or consequential damages, so the above limitation or exclusion may not apply to you.

This warranty gives you specific legal rights. You may also have other rights which vary by state.



## Questions & Answers about Genuine Eureka/Sanitaire Products

**Q:** Why should I use only Genuine Eureka/Sanitaire paper bags, belts, and parts in my Eureka/Sanitaire vacuum cleaner?

**A:** **Using Genuine Sanitaire Products, which are made to our exacting specifications and engineered with emphasis on quality, performance, and customer satisfaction, ensures the long life and cleaning efficiency of your vacuum cleaner. Overall, this saves you money and helps to keep your home clean.**

**Q:** How can I be sure I am using only Genuine Eureka/Sanitaire products in my vacuum cleaner?

**A:** **Typically, packaged products and paper bags can be identified by a Eureka or Sanitaire logo. For further identification assistance, you may call our toll-free number, 1-800-800-8975, for the location of a nearby Eureka/Sanitaire Authorized Warranty Station.**

**Q:** Are there any differences between "made to fit" or "imitation" and Genuine Eureka/Sanitaire paper bags, belts, and parts?

**A:** **Yes, there are some very important differences in materials, quality, and reliability. Many customers have mistakenly purchased "imitation" paper bags and parts while thinking they purchased genuine. Unfortunately, many of these customers discovered the differences after they experienced related difficulties.**

**For Genuine Sanitaire Value, Accept No Imitations!**



**ELECTROLUX HOME CARE PRODUCTS NORTH AMERICA**

Bloomington, Illinois 61701